



उत्तर प्रदेश ग्रामीण बैंक UTTAR PRADESH GRAMIN BANK

(सरकार के स्वामित्वाधीन अनुसूचित बैंक)
(Scheduled Bank Owned by Government)

UPGB/ROJHS/PE/03/2025-26

Date: 27.11.2025

Tender for Furnishing, Electrical & Data Cabling of Garotha Branch of Jhansi Region.

Uttar Pradesh Gramin Bank Regional Office-Jhansi invites sealed tender for furnishing, electrical and data cabling for our Branch at Garotha, District Jhansi from **the empaneled furnishers of Uttar Pradesh Gramin Bank** Head Office, 2nd and 3rd floor, NBCC Commercial Complex, Vardankhand, Gomti Nagar Extension Lucknow 226010.

Tender Issuing Date :	27-11-2025
Last Date Of Submission Of Tender :	17-12-2025 till 3:00 PM
Date Of Opening Of Tender :	17-12-2025 at 4:00 PM at RO Jhansi (subject to availability of committee members)
Tender to be address to :	The Regional Manager Uttar Pradesh Gramin Bank Regional Office 803/B-1 Gwalior Road, Jhansi -284003 (U.P.)
Website :	https://upgb.bank.in
Contact :	Rajendra Kr.Sharma (7318289707)

Terms & conditions of the tender:

- ❖ Rates should be quoted on the space provided in the attached annexure only. No other sheet/form should be used for quoting rates.
- ❖ **Rates quoted by only empanelled vendors will be considered/accepted.**
- ❖ The competent authority (bank) does not bind themselves to accept or to give any reasons for its decision of acceptance or rejection of tenders.
- ❖ Incomplete in any respect or conditional tender shall be liable to be rejected.

Other conditions:

- ❖ The registration number of the along with GST no. allowed by the authorities must be submitted.
- ❖ PAN Number of the firm allotted by the income tax authorities should be submitted (without which the vendor's bid would become invalid and shall be liable to be reject).
- ❖ Conditional tenders shall not be accepted on any ground and shall be rejected straight.
- ❖ Any deviation of the conditions given by the purchaser will not be accepted and bid will be rejected without assigning any reasons.
- ❖ If any clarification is required the same should be obtained before submitting the bid.
- ❖ The Entire document must be signed with the seal and attached as a mark of acceptance of the terms & conditions
- ❖ UPGB's reserve the right to accept or reject any bid whole or in parts without assigning any reason thereof.

क्षेत्रीय कार्यालय : 803/B-1, ग्वालियर रोड, झाँसी, उ. प्र. - 284003 / Regional Office: 803/B-1, Gwalior Road, Jhansi, U.P. - 284003
email- rmjhs@prathamaupbank.com





उत्तर प्रदेश ग्रामीण बैंक UTTAR PRADESH GRAMIN BANK

(सरकार के स्वामित्वाधीन अनुसूचित बैंक)
(Scheduled Bank Owned by Government)

- ❖ Bank's decision will be final and no correspondence will be entertained in this regard.
- ❖ In case of delay in submission/non-submission of bids, Bank will not assume any responsibility.
- ❖ Bank may reject any or all quotations without assigning any reason.

Tender Submission:

Submission of tender in sealed envelope super scribing "TENDERS FOR FURNISHING OF GAROTHA BRANCH, DISTRICT -JHANSI "AND ,"TENDERS FOR ELECTRICAL AND DATA CABLING OF GAROTHA BRANCH, DISTRICT -JHANSI"addressed to Regional Office 803/B-1 Gwalior Road Jhansi – 284003 (U.P.) Complete in all respect by 03:00PM 17-12-2025. Tenders received after shall not be entertained.

Tender must be submitted through hand to hand or through registered post only.

Evaluation of Tender:

Quoting incredibly low value of items with the view of subverting the tender process shall be rejected straight away.

Yours faithfully,

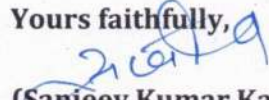
(Sanjeev Kumar Kanchan)
Regional Manager
Regional Office - Jhansi

Enclosure- Tender documents for interior furnishing, electrical & data cabling work for Branch Garottha.





उत्तर प्रदेश ग्रामीण बैंक
UTTAR PRADESH GRAMIN BANK

(सरकार के स्वामित्वाधीन अनुसूचित बैंक)
(Scheduled Bank Owned by Government)

IMPORTANT SCHEDULES

DATE OF ISSUE OF TENDER	: 27-11-2025
LAST DATE OF RECEIPT OF TENDER	: 17-12-2025 till 03:00 PM
DATE OF OPENING OF TENDER	: 17-12-2025 at 04:00 PM at RO Jhansi (subject to availability of committee members)
COMMENCEMENT OF WORK	: Within 5 days of issue of letter of intent/order
PERIOD OF COMPLETION	: 20 days from the date of issue of letter of Intent/order
RETENTION MONEY/DEPOSIT	: 5% of Gross Value from Each running Bill
REFUND OF RETENTION DEPOSIT	: to be refunded 14 days after giving in writing a request after end of Defects liability period.
INCOME TAX DEDUCTION	: At the Prevailing Rates from each bill.
DEFECTS LIABILITY PERIOD	: 12 months after completion of works
PERIOD OF FINAL MEASUREMENT	: 3 weeks from completion/ date of submission of Final Bill, whichever is later.

क्षेत्रीय कार्यालय : 803/B-1, ग्वालियर रोड , झाँसी, उ. प्र. - 284003 / Regional Office: 803/B-1, Gwalior Road, Jhansi, U.P. - 284003
email- rmjhs@prathamaupbank.com





उत्तर प्रदेश ग्रामीण बैंक
UTTAR PRADESH GRAMIN BANK

(सरकार के स्वामित्वाधीन अनुसूचित बैंक)
(Scheduled Bank Owned by Government)

ARCHITECTS

Mohit & Associates

L-2/554, Vineet Khand, Gomti Nagar, Lucknow

Mobile: 9582218092

mohit.gupta2783@gmail.com

क्षेत्रीय कार्यालय : 803/B-1, ग्वालियर रोड , झाँसी, उ. प्र. - 284003 / Regional Office: 803/B-1, Gwalior Road, Jhansi, U.P. - 284003
email- rmjhs@prathamaupbank.com





उत्तर प्रदेश ग्रामीण बैंक
UTTAR PRADESH GRAMIN BANK

(सरकार के स्वामित्वाधीन अनुसूचित बैंक)
(Scheduled Bank Owned by Government)

SECTION-I

INVITATION TO TENDERERS

SECTION- I

Sealed tenders on item rate basis are invited in the prescribed form by the REGIONAL MANAGER, Uttar Pradesh Gramin Bank, Regional office Jhansi

TenderNo	NameofWork	Time of Completion
RO/JHS /P.E./2025-26/03 Date : 27-11-2025	Furnishing and electrical & data cabling work of Garotha Branch	20 days

- 1.2 The work as detailed in this tender shall be executed and completed in all respects within the stipulated period in accordance with the Tender Document, Bill of Quantities, Drawings and Instructions, to the satisfaction of the Architects and the Employers.
- 1.3 Tenders filled in the prescribed form should reach the office of **Regional Manager, Uttar Pradesh Gramin Bank, Jhansi** latest by Date - 17-12-2025 till 03:00 PM in sealed covers and super scribed with the name of the work and the tender No. They would be opened on the 17-12-2025 at 04:00 PM in the presence of contractor/ authorized representative with Bank officers.
- 1.4 Rates must be quoted for complete work at site, inclusive of all costs, taxes, any other charges etc. All charges like Sales tax, Works Contract tax, E.S.I charges etc. would be borne by the contractor and Employer will not entertain any claim whatsoever in this respect.
- 1.5 The tenders shall remain valid for acceptance by the Employer for a period of 3 months from the date of opening the tenders.
- 1.6 The Retention Money will be refunded without any interest as per the schedule mentioned.
- 1.7 The **Defects liability period** will be 12 months from the date of completion of Work. Any defects found during this period in the various jobs executed by the contractor will have to be rectified by him, without any extra charges. In case the Employer finds that the contractor has not carried out the rectification, then he is at a liberty to get the same executed by another contractor and adjust the amount spend from the Retention money of the main contractor.
- 1.8 Tender documents (complete) duly filled and signed by the tenderers shall be submitted as the tender for the work.

क्षेत्रीय कार्यालय : 803/B-1, ग्वालियर रोड , झाँसी, उ. प्र. - 284003 / Regional Office: 803/B-1, Gwalior Road, Jhansi, U.P. - 284003
email- rmjhs@prathamaupbank.com





उत्तर प्रदेश ग्रामीण बैंक

UTTAR PRADESH GRAMIN BANK

(सरकार के स्वामित्वाधीन अनुसूचित बैंक)
(Scheduled Bank Owned by Government)

- 1.9 Uttar Pradesh Gramin Bank and the Architects, M/s Mohit Gupta & Associates do not bind themselves to accept the lowest or any tender, or to assign any reason thereof and also reserves the right of accepting the whole or part of the tender. The tenderers in such an event will be bound to perform the contract at the same rates as quoted in the tender for various works. Any item is liable for alteration at the discretion of the Architect & the Employer, if required.
- 1.10 Canvassing in any form in connection with the tender is strictly prohibited and the tenders submitted by the contractor who resorts to canvassing in any form will be liable for rejection.
- 1.11 The tendering firms, in case the tenderers are a partnership firm, shall submit the tender signed by all the partners.
- 1.12 On acceptance of the Tender, the Contractor shall intimate the name of his accredited representative who would be responsible for taking instructions from the architects and carrying out the works.
- 1.13 The successful tenderers will extend full co-operation with other contractors appointed by the employer, so that the work shall proceed smoothly. The main responsibility of the overall completion of the work in time will lie with the Furnishing Contractor.
- 1.14 The successful tenderers will need to sign the agreement, three sets, on stamp paper of Rs 100/- only. Tenderers failure to make such an agreement within the stipulated timeframe will amount to non- acceptance on his part. In this case the Employer will have the right to revoke the acceptance of tender without any further notice to the tenderers.

For calculation of L-1 rates of furnishing and electrical work will be taken separately.





उत्तर प्रदेश ग्रामीण बैंक
UTTAR PRADESH GRAMIN BANK

(सरकार के स्वामित्वाधीन अनुसूचित बैंक)
(Scheduled Bank Owned by Government)

SECTION-II INSTRUCTIONS TO TENDERERS

- 2.1 The tenderers are advised to visit and inspect the site at his own cost and responsibility and to secure all necessary information which may be required for completing the tender. Ignorance of site conditions or local information shall not be considered as an excuse for non- performance of the contract or any increase in the rates quoted byhim.
- 2.2 The tenderers shall examine carefully all the tender documents consisting of:
- Invitation toTenderers
 - Instructions toTenderers
 - General and Special Conditions ofContract
 - Bill of Quantities
 - Set of Drawings
- All the above shall form Part of the agreement.
- 2.3 Time is the essence of contract and the tenderers are required to complete the works in all respects to the satisfaction of the Architect & the Employer within the stipulated time.
- 2.4 The tender should contain the rates & the amount (both in figures and words), in the prescribed column of the BOQ. All the items should be totaled up in the end. All corrections should be duly attested by the tenderers. In case of any discrepancy between rates and amounts, the lower value will be taken for the finalizing of the tenderamount.
- 2.5 It shall be clearly understood that the rates quoted in the tender are to be, for complete work at site, as per the instructions to Tenderers, Conditions of Contracts, Specifications and Drawings and also for all such works as become necessary for proper completion of works, although specific mention thereof may not have been made in the specifications or drawings of tender documents. The rates shall be firm and not subject to cost escalation on account of labor and material conditions or any other reasonwhatsoever.
- 2.6 The tenderers shall use only the form issued with this tender to fill up therates.
- 2.7 Every page of the tender shall be signed on the left hand side bottomcorner.
- 2.8 The Contract will be governed by the Indian Contract Act, Indian Sale of Goods Act and all other relevant Laws. All payments due to the contractor under the contract will be made in Indian Rupees Currency.





उत्तर प्रदेश ग्रामीण बैंक
UTTAR PRADESH GRAMIN BANK

(सरकार के स्वामित्वाधीन अनुसूचित बैंक)
(Scheduled Bank Owned by Government)

SECTION-III FORWARDING LETTER

TO,

The Regional Manager
Uttar Pradesh Gramin Bank
Regional Office
Jhansi-284003

FROM

Ref: TenderNo

Dear Sir,

With reference to the tender invited by you, I/we hereby offer to perform, provide, execute and complete the works in conformity with conditions of contract, drawings and specifications for the respective items of schedule of quantities attached hereto.

I/we have satisfied ourselves as to the location and prevailing conditions of the site, and have read carefully the Articles of Agreement, Conditions of Contract, Specifications, General and Special Conditions, Technical Specifications, etc. I/we understand that the works are to be completed within----- days from the date of issue of letter of Intent/ Order and fully understand that time will be the essence of the contract.

I/we agree to keep the offer open for 90 days from the date of opening the tender.

Should this tender be accepted in whole or part, I/we hereby agree to abide by and fulfill all the terms and conditions annexed hereto.

All the terms and conditions of tender have been fully read by me/us. I/we accept the same and sign hereunder in token of their acceptance.

We further enclose the following documents: -

- i) Partnership deed, Article of Association and Power of Attorney, as applicable. We agree that no change will be made in these documents without prior approval of Uttar Pradesh Gramin Bank
- ii) Tender document duly signed.
- iii) Details of my firm

Name of Partners/ Directors

Yours Faithfully

Date :

क्षेत्रीय कार्यालय : 803/B-1, ग्वालियर रोड , झाँसी, उ. प्र. - 284003 / Regional Office: 803/B-1, Gwalior Road, Jhansi, U.P. - 284003
email- rmjhs@prathamaupbank.com





उत्तर प्रदेश ग्रामीण बैंक
UTTAR PRADESH GRAMIN BANK

(सरकार के स्वामित्वाधीन अनुसूचित बैंक)
(Scheduled Bank Owned by Government)

SECTION -IV
GENERAL CONDITIONS OF CONTRACT

4.1 DEFINITIONS

In this contract, the following words and expression shall have the meaning thereby assigned to them unless the contract ascribed a different meaning

- a) **Employer** means Uttar Pradesh Gramin Bank and includes their authorized representatives to deal with any matter on their behalf.
- b) **Employer- in - charge** means the person appointed by the Employer and notified to the Contractor to be in charge of the project
- c) **Clerk of Works** means any Engineer appointed by the Employer to perform the duties of Resident Engineer, limited to Supervision of Work and notified to the Contractor to be in charge of the project
- d) **Architects** mean the Architects Employed by Uttar Pradesh Gramin Bank to give consultancy.
- a) **Contractor** means the individual, firm or Company with whom the contract is entered into and includes the heirs, executors, or successors.
- b) The expression **Contract** means the document forming the Tender and acceptance thereof and included all the sections of the tender including BOQ and set of drawings.
- c) **Tender** means the offer made by an individual or firm or company for execution of the works.
- d) **Acceptance of Tender** means the letter from the Employer communicating to the tenderer the acceptance of this tender and include the advance acceptance of his tender.
- e) **Drawings** means the drawings referred to in the tender documents including any modifications of such drawings approved in writing by the Architect or his representative and such other drawings as are made from time to time and furnished by the contractor and approved by the Architect.
- f) **Site** means the actual place as described in the tender at which the execution of works is to be done with the surrounding areas.
- g) **A Week** shall mean 7 days without regard to the number of Hrs. worked in a day in that week.
- h) **Specifications** means standard specifications for works and materials brought out in the tender, and added to or superseded by special specifications. In absence of any specifications for any item of work the relevant specifications in CPWD or IBA works Manual shall be followed and work be executed accordingly.





उत्तर प्रदेश ग्रामीण बैंक
UTTAR PRADESH GRAMIN BANK

(सरकार के स्वामित्वाधीन अनुसूचित बैंक)
(Scheduled Bank Owned by Government)

4.2.1 EXTENT OF CONTRACT

The contractor shall supply at his own cost all the materials like ladders, scaffoldings, temporary works that may be required for the proper execution of the works, whether original, altered or substituted works. The contractor shall also supply survey instruments and other materials necessary for purpose of setting out of works and assisting to the measurements or examination at any time.

The contractor shall also provide a sufficient portion of fencing and lights required to protect the public from accidents and shall be bound to bear any expenses of defense brought by any person for injury sustained owing to neglect of the above precautions, and to pay any damages and costs which may be awarded in any such suit, action or proceedings to any such person. In no case the Employer shall be a party to any such claim and the Contractor shall indemnify the Employer against any claim for any person on this account.

4.2.2 Sufficiency of Tender

The Contractor shall be deemed to have satisfied himself before tendering as to the correctness and sufficiency of his tender for the works and his prices for the work which shall cover all his obligations under the Contract and all matters and things necessary for the proper completion and maintenance of the work.

4.2.3 Sub- Letting of Contract

The contractor shall not assign the contract or any part thereof to any other party without the prior written consent of the Employer.

4.2.4 Power to make alterations

Architect shall have the powers to make any alterations or additions to the stipulated specifications, drawings, designs and instructions that he may feel necessary or advisable during the progress of the work. The contractor shall have no claim for compensation on account of such alterations or additions. The contractor shall be bound to carry out the work in accordance with any instructions which may be given to him in writing signed by Architect and such alterations shall not invalidate the Contract, and any additional work which the Contractor may be directed to do in the manner above specified as part of the work shall be carried out by the contractor.





उत्तर प्रदेश ग्रामीण बैंक UTTAR PRADESH GRAMIN BANK

(सरकार के स्वामित्वाधीन अनुसूचित बैंक)
(Scheduled Bank Owned by Government)

The time for completion and Costs of such additional works shall be extended in proportion to the original contract. The certificate of the Architect shall be conclusive as to such proportions.

4.2.5 Works subject to approval of Architect

All works to be executed under the contract shall be subject to approval of the Architect who shall be entitled to direct at what points and in what manner they are to be commenced.

4.2.6 Urgent repairs and Urgent Works

If by any reason, during the execution of the work or during the defects liability period, any works or repair become urgently necessary and the Contractor is unable / unwilling to do such work immediately, then the Employer may get the same done on their own and deduct the cost thus incurred from the funds due to the contractor.

4.2.7 Clearance of Site

The Contractor shall have to remove all Malbaa from site of work, dirt and dust, etc. before handing over the works to the Employer. The works shall not be treated as complete in all respects unless these requirements are fulfilled.

In the event the Contractor failing to do so the architect and the employer shall have the right to get the site cleared at the contractors' risk and cost.

4.2.8 Protection of Trees and Shrubs

Trees and Shrubs designated by the Architect shall be protected from damage during course of the work and the earth level shall not be changed within three feet of such trees.

4.3 ARCHITECTS STATUS AND DECISIONS

- a) The Architect shall have General supervision & direction of Works. He has authority on behalf of the Employer to stop the work whenever such stoppage may be necessary to ensure proper execution of the works. The Architect shall be the interpreter of the conditions of Contract and the judge of its performance.
- b) The Architect within reasonable time make decisions of all claims of the contractor and all other matters related to the execution and progress of work.





उत्तर प्रदेश ग्रामीण बैंक UTTAR PRADESH GRAMIN BANK

(सरकार के स्वामित्वाधीन अनुसूचित बैंक)
(Scheduled Bank Owned by Government)

The decision of the Architect with respect to all or any of the following matters shall be final

1. Variation/ Modification of the Design
 2. Quality and Quantities of Works Executed
 3. Discrepancies in the drawings and Specifications
 4. Opening up for inspection of any work covered up.
 5. Amending of any defects occurring under Defects Liability Period
- c) The Contractor shall on the report of the Architect immediately dismiss from the works within 24 hrs. any person employed thereof by him who may in the opinion of the Architect/ Employer be incompetent/ misconduct himself.

4.4 DIRECTIONS REGARDING DRAWINGS & DESIGN

- a) After signing the Contract, the Contractor will be given three sets of drawings free of charge. Additional copies if required would be made at his own costs. One set of the drawings shall be kept at the site by the contractor and available to Architect/ his representative at all times.
- b) Further drawings and Instructions including revisions, as the Architect may furnish to the contractor shall form part of this contract.
- c) Only figured dimensions and detailed drawings shall be followed. The Contractor shall verify all dimensions in the field before any work is commenced and obtain instructions of the Architect in case of any discrepancy.

Action where no specifications

In case of any work for which there are no specifications in the contract, such works shall be carried out in accordance with the directions of the Architect.

4.5 DIRECTIONS FOR EXECUTION OF WORKS

4.5.1 Setting Out

The Contractor shall be responsible for the true and proper setting out of works. If at any time during the progress of the work any error shall appear in any part of the work, the Contractor shall rectify the errors. The checking of any setting out by the Employer/ Architect shall not in any way relieve the contractor of his responsibility for the correctness thereof.





उत्तर प्रदेश ग्रामीण बैंक UTTAR PRADESH GRAMIN BANK

(सरकार के स्वामित्वाधीन अनुसूचित बैंक)
(Scheduled Bank Owned by Government)

4.5.2 Engagement of labor

The Contractor shall employ labor in sufficient numbers to maintain the required rate of progress and Quality of work. No child labor will be employed by the Contractor.

The contractor shall comply with all the provisions of Minimum Wages Acts, Industrial Disputes Acts, ESI Acts.

The Contractor shall indemnify the Employer against any payment to be made under and for observance of the Regulations aforesaid without prejudice to his right to claim Indemnity from his sub- contractors.

The contractor shall provide at his own cost for the protection of the works and for the Safety of those employed on works or the Public.

4.5.3 Water and Power Requirements

All arrangements for water and Power required shall be made by the Contractor at his own costs and nothing extra on this account shall be paid to him. Similarly, filtered water required for drinking purposes for the laborers shall also be arranged by the Contractor at his own cost.

The contractor shall make necessary arrangements for procuring petrol/ diesel for machinery or for Power generation to ensure uniform progress of work in the event of Power failure.

No extension of time of completion of the contract shall be allowed on account of Power failure.

4.5.4 Disruption of Progress

The Contractor shall give written notice to the Architect whenever progress of work likely to be delayed. The notice shall include details of the drawings or order required and of why and when it is required and of any delay likely to be suffered if it is late.

If for any reason, within reasonable time, the Architect is unable to give directions, and the work suffers, then the Architect shall take such delay into account in determining any extension of time to which the Contractor is entitled.

4.5.5 Rectification of Defects

If it appears to the Architect that any work has been executed with imperfect workmanship or inferior material, then the Contractor shall rectify/ reconstruct the part so specified.

4.5.6 Samples

Samples of all materials to be used in works, shall be submitted for approval to the Architects, within four days of commencement of Contract.





उत्तर प्रदेश ग्रामीण बैंक
UTTAR PRADESH GRAMIN BANK

(सरकार के स्वामित्वाधीन अनुसूचित बैंक)
(Scheduled Bank Owned by Government)

The costs for preparing samples will be borne by the contractor.

4.5.7 Inspection of Works

All works in execution stage or executed shall be open to inspection and supervision of the Architect/ his representatives. During the Visit of the Architect, the Contractor or his representative should be available onsite.

4.5.8 Preparation of Program Schedule

The contractor, in consultation with the Architect shall prepare a program schedule of the various activities, before commencing of the works.

4.5.9 Extension of Time for Completion

If the contractor shall desire an extension of the time for completion of the work, on his having been unavoidably hindered in its execution or on any other ground, he shall apply in writing to the Architect within 3 days of occurrence of such hindrance and the extension he so desires.

The Architect, in consultation with the Employer shall, if, in his opinion will authorize such extension of time as may be proper.

4.5.10 Liquidated Damages for Delay

The time and Date stipulated in the contract for the completion of the work shall be deemed to be the essence of the contract. If the contractor fails to carry out the works within the stipulated time or the extended time if given, then he shall pay to UTTAR PRADESH GRAMIN BANK a sum of Rs. 5,000/- per week as Liquidated damages, for the period the works remain unfinished. The total amount of such a penalty shall not exceed 7.5% of the total Contract Price.

4.5.11 Defects Liability Period

The Contractor shall be responsible to make good and remedy at his own expense within such period as may be stipulated by the Employer any defects which may develop or may be noticed before the end of 12 months from the Certified Completion date and intimation of which has been send to the contractor within 7 days of the expiry of the said period.

If the Contractor, while rectifying the above defects, damages any other area of the site, will make good the related defects also at his own expense. In case he does not





उत्तर प्रदेश ग्रामीण बैंक UTTAR PRADESH GRAMIN BANK

(सरकार के स्वामित्वाधीन अनुसूचित बैंक)
(Scheduled Bank Owned by Government)

do so then the same would be got done by the Employer and expenses would be deducted from the amount due to the contractor.

4.6 MEASUREMENTS AND PAYMENTS

- 4.6.1 A bill supported with measurement details shall be submitted by the contractor fortnightly to the Architect for all works executed and the Architect or his Representative shall verify the requisite measurements. All bills shall be submitted in Triplicates.

All such intermediate payments to the contractor shall be regarded as payments by way of advance against the final payment and not as payments for works actually done and completed and shall not preclude the requiring of bad and imperfect work to be rectified or considered as an admission of due performance of the contract.

Income tax deductions will be made as per the prevailing rates from the contractor's on account bills.

4.6.2 Final Bill

Final bill supported with consolidated measurements of the full work executed shall be submitted by the contractor, the same will be verified by the Architect within Three weeks of Completion of Works.

After Verification, the Architect will give seven days' notice to the Contractor to Countersign the bill as a token of acceptance or intimate in writing his intention to dispute. If the Contractor fails to take appropriate action within the prescribed period as above, then the bill finalized by the Architect shall be final and binding on the Contractor.

4.6.3 Claim for Interest

No Claim for interest will be entertained by the Employer, with respect to any money balances as lying with the Employer.

4.6.4 Rates for Extra, Additional, Altered or Substituted works.

The rates for additional, altered or substituted work shall be worked out in accordance with the following provisions, in their respective order.

- i) If rates for similar works are directly available in the Contract for the work,





उत्तर प्रदेश ग्रामीण बैंक UTTAR PRADESH GRAMIN BANK

(सरकार के स्वामित्वाधीन अनुसूचित बैंक)
(Scheduled Bank Owned by Government)

the contractor is bound to carry out at the same rates as available in the contract.

- ii) If rates are not directly available in the contract, then they will be derived from the rates for a similar class of works as are specified in the contract.
- iii) If the rates cannot be determined, then the Contractor shall submit a detailed cost analysis as per market rates for same. The Architect will settle such claims.

4.7 GUARANTEES

4.7.1 Quality of Work

The Contractor shall guarantee that the materials and workmanship are the best of their respective kinds for the service intended and that all items of work will be free from all inherent defects in workmanship and materials. He shall also guarantee that the works will not fail in any respect due to quality of materials, workmanship and method of construction.

The Specifications assume a proper degree of Skill on the part of the Contractor and Workmen Employed. The Contractor shall consult the Architect, whenever in his judgment variation in the methods of Construction or in the quality of material would be beneficial or necessary to fulfill the guarantee called for. Such variations may be made by the Contractor, only when authorized by the Architect.

4.7.2 Cost of Execution of work or repair, etc.

All works of repair shall be carried out by the contractor at his own expense if the necessity thereof shall in the opinion of the Architect be due to the use of materials or workmanship not in accordance with the contract or on account of neglect or failure on the part of the contractor to comply with any obligation expressed or implied on the contractor's part under the contract.

4.7.3 Remedy on Contractor's failure to carry out the works required.

If the contractor shall fail to do any such work as the aforesaid required by the Architect. The Employer shall be entitled to carry out such works at the contractor's own cost and recover the same from any money that may become due to the contractor.

4.7.4 Contract Valid during Guarantee Period

This contract shall remain valid and in force until the expiry of Guarantee Period.





उत्तर प्रदेश ग्रामीण बैंक UTTAR PRADESH GRAMIN BANK

(सरकार के स्वामित्वाधीन अनुसूचित बैंक)
(Scheduled Bank Owned by Government)

4.8 RESCINDING/ TERMINATE CONTRACT

4.8.1 In any case under any clause of this contract, the contractor has rendered himself liable to pay compensation amounting to whole of his retention deposit in hands of Employer, the Architect in consultation with the Employer, on his behalf shall have power to adopt any of the following courses-

- a) To rescind the contract (of which rescission notice in writing to the contractor shall be conclusive evidence)
- b) To employ a contractor paid by the Employer and to supply materials to carry out the work or any part of the work, debiting the contractor with the cost of the labor and the price of the materials.
- c) To measure up the work of the contractor and to take such part of the work of the contractor as shall be unexecuted out of his hands and to give it to another contractor to complete. In this case any expense which may incur in excess of the sum which would have been paid to the original contractor, if the whole work had been executed by him, shall be borne and paid by the original contractor and may be deducted from any money due to him by the Employer.

In the event of any of the above courses being adopted by the Architect, the Contractor will have no claim to compensation to any loss sustained by him.

4.8.2 Termination of the Contract

If at any time after the commencement of the work the Employer for any reason whatsoever not require the whole or part thereof as specified in the tender to be carried out, Architect shall give notice in writing of the fact to the Contractor who shall have no claim to any payment or compensation whatsoever on account of any profit or advantage which would have derived from the execution of the work.

4.8.3 Jurisdiction

The contract and its operation shall be governed by the laws of India, for the time being in force. The contract shall deemed to have been entered into a **Regional Office Jhansi.**

4.8.4 Bye Laws and Local Authorities

The contractor shall conform to the provisions of any Govt. Acts and regulations of Local Authorities. Contractor would pay all charges and fees for towards





उत्तर प्रदेश ग्रामीण बैंक
UTTAR PRADESH GRAMIN BANK

(सरकार के स्वामित्वाधीन अनुसूचित बैंक)
(Scheduled Bank Owned by Government)

Stacking, etc. The Contractor shall keep the Employer indemnified against all penalties and liabilities incurred in connection with the said contract.

The contract will be governed by the Indian Contract Act, Indian Sales Act and all other relevant laws.

4.8.5 Arbitration

All disputes related to the said contract shall be referred to the arbitration of the person appointed by the Employer. All rules will be subject to Arbitration Act 1940, or any statutory modification or re-enactment thereof.

It is a term of the contract that if the Contractor does not make any demand for arbitration in writing within 30 days of receiving the intimation from the Employer that bill has been certified for Payment, the claim of the contractor will be deemed to have been waived absolutely barred and the Employer shall be discharged and released of all liabilities under the contract.

4.8.6. Discretion

Bank can at any time cancel/alter/modify the terms and conditions mentioned herein before signing the contract. All conditions are at so Uttar Pradesh Gramin Bank i.e. discretion of the bank.





उत्तर प्रदेश ग्रामीण बैंक
UTTAR PRADESH GRAMIN BANK

(सरकार के स्वामित्वाधीन अनुसूचित बैंक)
(Scheduled Bank Owned by Government)

SECTION -V
FORM OF AGREEMENT

This agreement made at.....day of.....2023..... between Uttar Pradesh Gramin Bank, Regional Office, Jhansi (hereinafter referred to as the Employer which expression shall include their heirs, executors, administrators and assigns) of the one part and.....of or whose registered office is situated at..... (here in after referred to as Executors which expression shall include their heirs, executors, administrators and assigns) of the other part.

WHEREAS the Employer is desirous of.....
..... (here in after called "the work") at.....
and has caused drawings and BOQ specifications describing the work to be done to be prepared by.....and whereas the contractor supplied the employer with a fully priced copy of the said bills of quantities (which copy hereinafter referred to as "the contract bills) and whereas the said drawings and Specifications and the Price Schedule of Quantities have been signed by both the parties and the contractor has agreed to execute upon.

NOW IT IS HEREBY AGREED AS FOLLOWS

In consideration of the said contract, payments to be made to the contractor as hereinafter provided he shall upon and subject to the said conditions execute and complete the works shown upon the said drawings and such further detailed drawings as may be furnished to him by the said Architects and described in the specifications and the said Priced Schedule of Quantities.

The Employer shall pay the Contractor such sums as shall become payable hereunder at the times and in the manner specified in the said conditions.

The said Contract comprises the building above mentioned and all subsidiary works connected there within the same site as may be ordered to be done from time to time by the said Architects even, though such works may not be shown on the Drawings or described in the said Specifications or the Priced Schedule of Quantities.

The Employer through the Architect reserves to himself the right of altering the drawings and nature of the work and adding to or omitting any items of work or of having portions of the





उत्तर प्रदेश ग्रामीण बैंक UTTAR PRADESH GRAMIN BANK

(सरकार के स्वामित्वाधीन अनुसूचित बैंक)
(Scheduled Bank Owned by Government)

same carried out otherwise and such alterations shall be carried out without prejudice to this contract.

The Employer in consultation with the Architect reserves the right to exercise control on quality of work, check the measurements, approval of rates of extra or substituted items. The decision of the Architect shall be final and binding in this regard.

The following documents shall be deemed to form and construed as part of this agreement along with the amendments, negotiated and confirmed in various subsequent letters exchanged as mentioned hereinafter and parties hereto will respectively abide by and submit themselves to the Conditions and Stipulations and perform the agreement on their parts respectively in such conditions contained

- a) Notice inviting Tender
- b) Instructions to Tenderers
- c) General Conditions of Contract
- d) Special Conditions of Contract
- e) Technical Specifications
- f) Schedule of Quantities
- g) Employers letter dated..... to the Contractor awarding the Contractor awarding the Contract
- h) Contractors letter dated.....to the Employer in acceptance of the award of Contract

2. All dispute arising out of or in any way connected with the agreement shall be deemed to have arisen at **Jhansi**, the Court in **Jhansi** shall have jurisdiction to determine the same.

Witness

SIGNED BY THE SAID EMPLOYER

Witness

SIGNED BY THE SAID CONTRACTOR





उत्तर प्रदेश ग्रामीण बैंक

UTTAR PRADESH GRAMIN BANK

(सरकार के स्वामित्वाधीन अनुसूचित बैंक)
(Scheduled Bank Owned by Government)

INVITATION TO TENDERERS

PROJECT - SPECIFICATION FOR FURNITURE WORKS.		
BANK- UTTAR PRADESH GRAMIN BANK		
*ALL WORKS TO BE DONE AS PER TENDER CONDITIONS.		
A	FURNITURE ITEMS	
1	LAMINATES (IS-2046) / VENEER	GREEN LAM / CENTURY / ARCHID / FORMICA / SUNMICA
2	COMMERCIAL PLY (IS-303) / WATERPROOF PLY (IS-710) / BLOCK BOARD (IS-1659) / FLUSH DOOR (IS- 2202)	ARCHID/ CENTURY / GREEN
3	ADHESIVES	FEVICOL / VAMICOAL
4	LOCKS	GODREJ
	MULTIPURPOSE GROUP LOCK	E-MPL1-22 / E-MPL1C-22 (EBCO)
	NIGHT LATCH	8812 (GODREJ)
	CYLINDRICAL LOCK (SS MATT FINISH)	3792-WITH KEY AND 3786-KEYLESS (GODREJ) / C120SS (EUROPA)
	MORTISE DEAD LOCK (TWO WAY)	8815(GODREJ)
	MORTISE LOCK WITH DOOR HANDLE	MATIZ 8083(GODREJ)
5	DRAWER CHANNELS	GODREJ/ HATTICH/ OZONE
	TELESCOPIC CHANNELS (ZINK PLATED)	STDS35(I)35/ STDS25(I)35/ STDS50(I)35/ STDS60(I)35 (EBCO)
	BOTTOM CHANNELS (POWDER COATED)	BMDS 35/ BMDS 37/ BMDS 55/ BMDS 60 (EBCO)
6	GENERAL HARDWARE	SS MATT FINISH
	DOOR STOPPER	I) BLACK/IVORY/BROWN/SILVER COLOR POWDER COATED DS1 (EBCO) II) SPRING TYPE BLACK/BROWN/IVORY COLOR POWDER COATED (ECGL'S STERLING)
	HINGES	I) 3"/4"/5"/6" 1.8MM TH. SS MATT FINISH (SUZU) II) 75X12X19 1.2 MM TH. SS MATT FINISH FOR STORAGE (SUZU) III) AUTO CLOSE HINGES – SLIP ON HINGE- EURO / CLICK ON HINGE-I (EBCO) FOR STORAGE
	HANDLES 'D' OR 'C' TYPE	1) 3"/4"/6"10MM DIA SS 202 MATT FINISH (ANJALI)
	TOWER BOLT	3"/4"/6"/8" BRASS EXTRUDED SS MATT FINISH (OSWAL)

क्षेत्रीय कार्यालय :803/B-1, ग्वालियर रोड , झाँसी, उ. प्र. –284003 / Regional Office:803/B-1, Gwalior Road, Jhansi, U.P. - 284003
email- rmjhs@prathamapbank.com





उत्तर प्रदेश ग्रामीण बैंक

UTTAR PRADESH GRAMIN BANK

(सरकार के स्वामित्वाधीन अनुसूचित बैंक)
(Scheduled Bank Owned by Government)

	SLIDING CHANNEL	EBCO MAKE APPROVED BY ARCHITEC/BANK.
7	FLOOR SPRING	RITZ,HYPER,EVERITE (ISI Mark)
8	DOOR CLOSURE	RITZ,HYPER,EVERITE (ISI mark)
9	PATCH FITTINGS FOR DOOR AND FIXED GLASS PARTITION (TOP/BOTTOM PATCH, PIVOT, PATCH LOCK, L ARM, L CONNECT, CONNECTOR, FLOOR SPRING, HANDLE, PLASTIC PROFILE)	GODREJ / XL C SERIES(DORMA) / OPF SERIES (OZONE)
10	GLASS / MIRRORS	SAINT GOBAIN / MODI
11	ALUMINUM SECTION	JINDAL / HINDALCO
12	WINDOW BLINDS	VISTA / AEROLUX/HUNTER DUGLUS / MAC
13	POLISH / PAINT	ASIAN PAINTS / BERGER / NEROLAC
14	PARTICLE BOARDS	NOVAPAN / KITLAM/DECO BOARD
15	COMPUTER ACCESSORIES	
	CPU HANGER/ SHELF	SIDE MOUNTED IS CPU HL SM (INNOFITT) /CPUSM(EBCO) , 4/2-SMCS (ZIPCO)
	CABLE MANAGER (60MM)	I) METAL - CO60ZN1(EBCO) II) PVC - CO 60 (EBCO) BLACK/IVORY/GREY COLOR
16	ACP PANEL	TIMEX / ALU DECOR / EURO
19	WHITE FILM FOR GLASS	CRYSTAL / SONA MAKE VINYL FROSTED FILM
B	PAINTS	ICI, ASIAN,DULUX, BERGER, NEROLAC, JOHONSON & NICOLSAN
1	ANTI CORROSIVE PAINT	TIKITAR, FINCOAT
2	RED OXIDE	ASIAN, DULUX,NEROLAC
3	POLISH	ASIAN MELAMINE
4	EXTERIOR PAINTS	DULUX WEATHERSHIELD OR APP. EQUIVALENT
5	ENAMEL PAINT	ICI, DULUX, ASIAN, NEROLAC
C	FALSE CEILING	
1	GYPSUM BOARD	GYPROC (SAINT GOBAIN)
2	FRAMING WITH COMPLETE SYSTEM	GYP STEEL ULTRA (SAINT GOBAIN), RAMCO FUJI
3	HILUX BOARDS	RAMCO OR APPROVED EQUIVALENT
4	MINERAL FIBRE TILES CEILING WITH COMPLETE SYSTEM	ARMSTRONG/SAINT GOBAIN/USG

क्षेत्रीय कार्यालय :803/B-1, ग्वालियर रोड , झाँसी, उ. प्र. -284003 / Regional Office:803/B-1, Gwalior Road, Jhansi, U.P. - 284003
email- rmjhs@prathamaupbank.com





उत्तर प्रदेश ग्रामीण बैंक

UTTAR PRADESH GRAMIN BANK

(सरकार के स्वामित्वाधीन अनुसूचित बैंक)
(Scheduled Bank Owned by Government)

PROJECT - SPECIFICATION FOR ELECTRICAL WORKS.

BANK- UTTAR PRADESH GRAMIN BANK

*ALL WORKS TO BE DONE AS PER TENDER CONDITIONS.

D	APPROVE MAKE LIST FOR ELECTRICAL WORK	
1	PVC rigid conduits & Accessories:	1.5 mm thick (MMS) ISI and FIA approved - Precision / Vraj / Nihir / BLP / PFI / Anchor / Polycab make. (Only white coloured pipes FRLS type to be used.).
2	L.T. Cables:	Havells / KEI / Polycab/ Finolex.
3	Wires (FRLS):	Havells / KEI / Polycab/ Finolex.
4	Main Distribution Boards:	MDS Legrand (Lexic) / Hager / Crabtree XPOA / Schneider (Eazy 9) / L & T EXORA / C & S Wintrip / Siemens Bitaguard.
5	ELCB / RCCB / Miniature Circuit Breaker:	MDS Legrand (Lexic) / Hager / Crabtree XPOA / Schneider (Eazy 9) / L & T EXORA / C & S Wintrip / Siemens Bitaguard.
6	Switch gears:	MDS Legrand (Lexic) / Hager / Crabtree XPOA / Schneider (Eazy 9) / L & T EXORA / C & S Wintrip / Siemens Bitaguard.
7	Change Over Switch:	HPL Socomac/ Havells / L & T / Hager.
8	Domestic fittings:	
	a) All Switching Modular Accessories.	MK Wrapped Wround Plus / Schneider Livia / L & T entis / Crabtree Verona / Salzer Elite / Legrand Myris / C & S Divino / SSK Ace.
	b) Holders / ceiling roses	Anchor
	c) Adhesive Tape	Bhor (Steel Grip) .
9	10 - 30 A Polycarbonate Socket & Top:	MDS Legrand (Lexic) / Hager / Crabtree XPOA / Schneider (Eazy 9) / L & T EXORA / C & S Wintrip / Siemens Bitaguard.
10	Telephone Wires / Cable:	Finolex / Havells / L & T / Polycab.
11	Telephone tag block:	Krone make.
12	Cable Lugs:	Dowell / Lotus / Jainson / 3 D.
13	Cable gland Single / Double Compression:	HMI / Comet / 3D.
14	Ammeter / Voltmeter:	AE / HPL / MECO/ Enercon make.
15	Selector switches:	L & T salzer / Kaycee make.
16	Indicator lamps:	LED type Teknic / Precifine/ Binay.
17	Connector strips:	Wago / Elmex make.
18	Lighting Fixtures :	Wipro / Philips / GE / Crompton. only
19	Exhaust fan (Light duty):	Khaitan / Crompton / Havells.
20	Ceiling Fan (5 star rated):	Crompton (High Breeze Plus) / Havells.
21	Wall mounted Fan (5 star rated):	Crompton (High Flow Wave) / Havells.
22	Data Cable - I / O Unit:	D - Link / Digi Link.

क्षेत्रीय कार्यालय : 803/B-1, ग्वालियर रोड , झांसी, उ. प्र. - 284003 / Regional Office: 803/B-1, Gwalior Road, Jhansi, U.P. - 284003
email- rmjhs@prathamaupbank.com



B.O.Q OF FURNISHING WORK UP GRAMIN BANK BRANCH AT GARAUTHA-JHANSI					
A	SCHEDULE - 'A' (FURNISHING WORK)				
S.NO.	DESCRIPTION	UNIT	QTY.	RATE	AMOUNT
A	SUSPENDED FALSE CEILING				
A.1	FALSE CEILING (GYPSUM BAORD)				
	Providing and fixing Gypsum false ceiling as per drawing including of providing and fixing G.I. Frame work shall comprise of G.I. perimeter channel (MF-6A) of size 0.50mm thick having one flange of 19.6mm and another flange shall be of size 29.6mm and a web of 26.6mm along with perimeter of ceiling, screw fixed to the beam to the required curvature with nylon sleeves and screws at not exceeding 610mm centers. Then suspending G.I. intermediate channel (MF-7) of size 45mm, 0.9mm thick with two flanges of 15mm each bent to the required curvature by cutting both its flanges. Suitable bracing to be provided where ever the flanges are cut with 0.9mm G.I. Flat and nuts and bolts at specific positions and thereafter at 1220mm centers with ceiling angle of width 25mm x 10mm x 0.50mm thick fixed to soffit with G.I. cleats and steel expansion fasteners as per specification of India gypsum at a distance of 2'0" c/c both ways complete with 12.5mm board and all necessary perimeter channels etc.	Sq.Ft.	590.00		
	The joints to be properly mended with paper tapes and gypsum compound all complete. The boards are to be jointed and finished which includes filling and finishing the tapered and square edges of the boards with jointing compound and fiber tape suitable for Gypsum board. A layer up to of 3.00mm thickness of Veneer Plaster is applied followed by two coats of topcoat (primer) at the face of board to give smooth seamless finish. 2 or more coats of plastic emulsion paint (roller finish) of approved shade and make shall be applied. The rate should include the full completion of the ceiling. At the time of handing over the site all necessary repairing work to be considered if required. The work to be completed as per specification, approval of the bank. No Drop or design (if any) will be considered as extra measurement it will be considered flat ceiling. (Only plan area to be measured for payment). No extra payment will be made for the cutting of light points, stain glass, cove lighting etc. The measurement will be taken in one level, rate should include the drops also, no extra amount will be paid for the drops.				
A.2	FALSE CEILING (ARMSTRONG CEILINGS - FINE FISSURED MICROLOOK EDGE WITH SILHOUETTE GRID (BLACK REVEAL)				
	Providing and fixing false ceiling system manufactured by M/s. Armstrong World Industries using hot dipped galvanized steel section, rotary stitched main tee of size 15mm x 42 mm web height, having 0.36 mm gauge at every 600 mm centre to centre maximum and rotary stitched cross tee of size 15 mm x 42 mm, having 0.33 mm gauge at every 600 mm. c/c. and wall angle of size 19 x 19 mm., having 0.35 mm gauge fixed to the periphery of the wall. The above grid is suspended at every 600mm c/c. in both directions using 2.0 mm. thick pre-straightened GI wire laying FINE FISSURED MICROLOOK WITH SILHOUETTE GRID (BLACK REVEAL) ceiling tiles manufactured by M/s. Armstrong World Industries, of size 600mmx600mmx15mm having NRC 0.55, Light reflectance of >84% (WT), thermal conductivity k = 0.052-0.057 W/m0K, Humidity Resistance of 99%, having Fire Performance CLASS 0 / CLASS 1 (BS 476), surface having 3 coats of white paint with Fine Fissured, back of the tile duly sanded and finished with a coat of protective paint over the formed grid complete.	Sq.Ft.	579.00		



S.NO.	DESCRIPTION	UNIT	QTY.	RATE	AMOUNT
1	PARTITIONS WORK				
1.1	FULL / LOW HEIGHT SOLID PARTITION / DOOR / UPS	Sq.Ft.	385.00		
	Full ht. Solid Partition up to ceiling only WITH LOUVRE :- Providing and fixing solid partition, the framing shall made out of aluminium hollow section of 65mm x 37mm size 1.5mm thick of JINDAL / INDAL as internal frame structure placed horizontally & vertically at max distance of 2'-0" x 2'-0" center to center. Fixing 6 mm thick commercial ply on both sides with 1.0mm thick laminate on top of approved shade with groove pattern as per instructions of Architect. The rate shall include the cost of providing skirting of 100mm wide lined with 1mm thk laminate and providing & fixing a border at top of 100mm wide lined with 1mm thk laminate complete. Laminate Should be considered up to two or three color combination. The edge beadings with steam beach wood should be finished with melamine polish if required, frame work above false ceiling done shall not be measured but contractor may factor it while quoting there rates as measurment up to false ceiling lvl..				
	The rate inclusive of providing & fixing of required flush door of 37mm thick approx. with 1.0mm th.laminate both side with steem beech wood chowkhat of size 75mm x 65mm approx and Item includes Heavy-duty SS ball bearing butt hinges 100 x 5.5 mm (4 Nos. per shutter) with screws etc.The shade of laminate finish to be got approved from Bank. All as per the design and instructions Bank.				
	Note :- For the purpose of payment partition shall be measured including the area of door/door frames up to false ceiling heaight.				
	Framework shall be regidly secured to floor, bottom of slab & exisitng walls at 2'-0" c/c with dash fasteners.				
1.2	Full height Glazed partition manager cabin	Sq.Ft.	180.00		
	Same as of Solid ht. partition, providing 8mm thick Modi/saint Gobin float glass above 1'-0" / 3'-0" & up to 7'-0" fixed with steam beech wood beading of finished size 1 1/2" X 1" all along the edge. All edge-to-edge glass joint to be machine cut and polished and sealed with silicon sealant, joint shall be located strictly as shown in the drawing. All exposed woodwork to.be mealamine polished. Item includes frosted/striped/designer glass film of 3m, Avery Dennison or equivalent (basic rate of Flim Rs. 50/ Sq.ft.) on existing glass as per manufacturer's specifications. All as per the design and instruction Bank.				
1.3	7' Height Glazed partition in Cash cabin	Sq.Ft.	85.00		
	Same as of Solid ht. partition, providing Aluminium grill jalli above 1'-0" / 3'-0" & up to 7'-0" fixed with steam beech wood beading of finished size 1 1/2" X 1" all along the edge. All exposed woodwork to be mealamine polished. All as per the design and instruction Bank.				
1.4	Low Height Semi Glazed in Counter	Sq.Ft.	100.00		
	Same as above but of Low height as per design including 10mm Toughened glass with edges polished to be used. All other specs are same as of above, Edges of the partition to be covered with 3" X 1.5" Steam beech wood duly melmine polished moulding. 38mm thick flush door: wicket gate also shall be included for a measurement. All as per the design and insturction bank.				
1.5	Front Glazeing in cash cabin	Sq.Ft.	15.00		
	Providing & fixing 10mm thick toughened clear float glass to shape for front side of the cash counters including cutting the holes and providing & fixing TW beading polished and tinted to approved shade. (including SWO/Chief Cashier front Glass).				
1.5	Aluminium grill on the ceiling of Cash cabin	Sq.Ft.	35.00		
2	DOOR & ACCESSORIES				
2.1	Main Entrance Door with Fixed Glazing powder coated	Sq.Ft.	90.00		
	Providing and fixing Powder coated aluminium entrance doors with 8 mm floatglass (3M frosted sticker) as/design with top & bottom section of 45 by 90mm, 2mm thick section of hindalco/indal anodized in approved colour with 25 micron anodizing along with SS C shaped handles of Kitch or equivalent make along with floor spring of hemco/everite make. The item also includes door lock completed to the satisfaction of the architect.				



S.NO.	DESCRIPTION	UNIT	QTY.	RATE	AMOUNT
2.2	Supplying and fixing of Dorma/GEZE Dline / Hardwyn/Godrej or approved equivalent Door Closer for wooden door for Cashier .	Nos	5.00		
2.3	Supplying and fixing of mortice door lock of hardwyn make HML-480 Lock Body 304 Stainless Stell. (in BM Cabin , Store room 0. Cash cabin shall be Godrej Night latch.	Nos	5.00		
2.4	Supplying and fixing of door stopper SS Grade 304, HESSF-2C hardwyn make.	Nos	6.00		
3	WORKING COUNTER				
3.1	CASH COUNTERS	Rft.	5.00		
	Providing and fixing Chief Cash Counter in split-levels @ 2'-6" (height 750mm) & 18" (1140mm) with 2'-6" & 15" wide each respectively . Upper levels having shall be finished with 1.0mm thick laminate of approved shade and colour with approved adhesive to 19 mm thick commercial ply top. Edges of 18" wide counter shall be finished with 1.0mm thick laminate of approved shade and colour. Lower tier shall be made of 19 mm thick ply wood finished in 1 mm thick laminate. Exposed edge having steam beech wood edging of size 1 ½" x 1". Vertical face shall have 19mm thick ply wood over pine wood framework as per requirement of design. All exposed surfaces shall be finished with 1.0mm thick laminate of approved shade and colour.				
	1 no. prefabricated metal computer key board tray including drawer slides 12.5" x 22" tray with 14" telescopic slides including L - brackets for securing to the table top. Chest of drawers (size 1'-4" x 2'-0" x 2'- 5") made of 19mm thick commercial ply wood having three drawers finished with 1.0mm thick Laminate on all sides. Each drawer shall have locking system and 6" long S.S. brushed finished handle, drawer slides etc. of approved make. All exposed edges of ply wood sealed with Steam beech wood beading of size ¼" x ¾". All beading and exposed wood shall be melamine polished and .75mm for interal area laminate . Item includes readymade metal powder coated CPU trolley, grommet, footrest for each seat. All complete as per approval and instructions of the Architect / employer.The rate also include providing and fixing painting a foot rest using hard wood 100 x 25mm size 1st class seasoned country frame.				
	Payment will be made only on the centerline measurement. The rate shall include the cost of providing skirting of 100mm wide lined with 1.0mm thk laminate and providing & fixing a border at top of 100mm wide lined with 1.0mm thk laminate complete.				
3.2	RUNNING COUNTER	Rft.	18.00		
	Providing and fixing staff counter/SWO @ 2'-6" (750 mm) shall be made of 19mm thick ply wood and finished in 1 mm thick laminate. Working top having steam beech wood edging of size 1 ½" x 1". Vertical face shall have 19 mm thick commercial ply over pine wood framework as per requirement of design. All exposed edges of ply wood sealed with Steam beech wood beading of size ¼" x ¾". All exposed surfaces shall be finished with 1.0mm thick laminate of approved shade.				
	The item includes Chest of drawers (size 1'-4" x 2'-0" x 2'- 5") made of 19mm thick commercial ply wood having One drawers at top and a storage cabinet below having shutters of 19mm thick ply wood finished with 1.0mm thick Laminate on all sides. 1 no. prefabricated metal computer key board tray including drawer slides 12.5" x 22" tray with 14" telescopic slides including L - brackets for securing to the table top for each seat. All beading and exposed wood shall be melamine polished and .75mm for interal laminate surface . Item includes 1'-3" high 12mm thick toughned glass above upper tier and readymade metal powder coated CPU trolley, grommet, foot rest for each seat. All complete as per approval and instructions of the Architect / employer.The rate also include providing and fixing painting a foot rest using hard wood 100 x 25mm size 1st class seasoned country frame. Payment will be made only on the centerline measurement.				
	The rate shall include the cost of providing skirting of 100mm wide lined with 1.0mm thk laminate and providing & fixing a border at top of 100mm wide lined with 1.0mm thk laminate complete.				



S.NO.	DESCRIPTION	UNIT	QTY.	RATE	AMOUNT
4	TABLE & FURNITURE				
4.1	MANAGER TABLE (Size:- 6'-0" x 2'-6") ht. 2'-6"	Nos	1.00		
	Providing and fixing tables made out of 19 mm thick commercial ply over hard wood frame work finished with 1.5mm thick laminate of approved shade. Top having steam beech wood edging of size 2" x 1 3/4". 8mm thick clear float glass with beveled edges shall be provided on the finished to 19mm thk Comm.ply wood of approved make cladded with 1mm thk. laminate(color with vertical grain) as per design in all visible areas. All the exposed edges to be covered with wooden steam beech lippings and mouldings duly malamine polish. The drawers to be made out of 19mm thk ply wood with 1.0 mm laminate finish in the front , and bottom to be made out of 6mm plywood and it should play in drawer sliding telescopic channels. The inside of the drawer to be .75mm lamintes & Table back side wil be 1mm laminate. A leg rest to be provided duly polished made out of 3"x2" Wooden Section.				
	A shutter to be made by 19mm ply wood cladded with 1.0mm laminate .The necessary locks handles to be provided in each drawers and shutters. 3" x 1/2" wooden skirting to be provided in all visible areas duly polished. The necessary wire managers(SS) to be provided on the tables and provision for lights to be kept if required in the front of the table. All the exposed areas to be duly malamine polished The work to be completed as per design and approval of the Bank. The table should have key board tray and CPU Trolley to be Modular. All as per the design and instructions Bank .				
4.2	OFFICER TABLE WITHOUT GLASS (Size:- 5'-0" x 2'-6") ht. 2'-6"	Nos	1.00		
5	STORAGE & SIDE UNIT				
5.1	Side Unit				
	Providing and fixing Side Unit/ Back unit 400 mm depth made out of 19mm ply wood finished with 1.0mm laminate in all exposed areas and top shall be 1.5 mm thick . The drawers to be made out of 19mm commercial plywood and cladded with 1.0mm laminate and bottom made out of 6mm comm ply duly painted in matching tone and it should play on drawer sliding channels . The shutters to be made out of 19mm commercial ply wood and should play on drawer sliding castors on powder coated channels. The necessary locks , handles, etc to be provided . 3" x1/2 wooden skirting to be provided duly polished as per matching tone all along the visible areas . Inside of the unit to be enamel painted in matching tone . All the exposed edges of the boards/ply woods to be coverd with woden lippings/mouldings duly polished all complete. The work to be completed as per approval and specification of the Architect.	NO	2.00		
5.2	Storage	Sq.Ft.	55.00		
	Providing and fixing Full /Low height Cabiner 1'-9" mm deep made out of 19mm thk plywood finished with 1.0mm laminate in all exposed areas . The Shutter to be made out of 19mm ply wood in the front cladded with 1.0mm laminate(color, vertical grain) . and bottom made out of 6mm plywood duly painted in matching tone and shelves 19mm thk comm ply wood to fixed inside storage. The shutters to be made out of 19mm ply wood . The necessary locks , handles, etc to be provided . 3" x1/2 wooden skirting to be provided duly polished as per matching tone all along the visible areas . Inside of the unit to be enamel paint finish . All the exposed edeges of the boards/plywoods to be coverd with wooden lippings/mouldings duly polished all complete.All as per the design and instructions Bank.				



S.NO.	DESCRIPTION	UNIT	QTY.	RATE	AMOUNT
6	OTHER MISCELLANEOUS ITEMS				
6.1	PIN UP / NOTICE BOARD				
	Providing and fixing soft board with necessary framework with 12mm BWR plywood on top 12 jolly board to be fixed finished with fabric @Rs80, with necessary mouldings duly polished along the periferi. All as per the design and instructions Bank.	NO	1.00		
6.2	WRITING LEDGER & Cheque & sugestion box	NO	1.00		
	Providing and fixing writing ledge as per design minium 5 ft length made out 19mm comm. board with necessary grove patterns with 1.0mm laminate. 10mm thk machine polished glass to be provided on top of the writing ledge. Small boxes to be made out of 12mm comm. ply to be made on top of the writing ledge finished with 1.0 mm laminate, inside enamel painted and rate should be included providing fixing of sugestion box & Cheque deposit box as per approval of bank .The work to be completed as per design and approval of the architect.				
6.3	Main Electrical Panel Cabinet				
	Providing and fixing of DB Shuttering formed of 12mm thk plywood wood on 12mm thick Gypsum board (fire Proof) with finsih as per Item no 1 for inside and out side shutters finished with laminate on outer surface with SS (4Nos) louvre perforation and necessary hardware,hinges etc complete as per details. All as per the design and instructions Bank.	Sq.Ft.	40.00		
6.4	Shutter boxing for ROLLING SHUTTER				
	P & F shutter boxing made of 19 m.m. phenol bonded ply IS 303 grade including hatch fir pulling down & up the rolling shutter.The box to be laminated with aluminium composite panel of 3.0 m.m. completed to the satisfaction of architect.Front surface will be taken for measurement only.	Sq.Ft.	80.00		
6.4	PILLAR WOODEN PANELLING	Sq.Ft.	200.00		
	Fabricating and fixing wall/column paneling, the framing shall made out of aluminium hollow section of 65mm x 37mm size 1.5mm thick of JINDAL / INDAL at spacing not exceeding 600mm bothways (horizontal and vertical). Paneling framework to be secured to wall surface/column surface.Paneling framework to be clad on one side with 9mm thick ply finished with 1.0mm thk laminate including skirting of 100mm high & 12mm x 12mm groove at skirting level. All as per the design and instructions Bank.				
6.5	Customer Table - (4'-0" X 2'-6")	No	1.00		
	Providing and making a table of over all size of top as mentioned above. It shall consist of ¾" thk. Comm. Ply top as per design (double edge on outer edge with 1 1/2" thk half moulding on the edges) supported on ¾" thk. Comm. Ply verticals.supported on wooden base (as designed by the architect). Suitable wooden moulding as architect design with mellamine shall be provided to the edge of the top. All external surfaces to be finished in 1 mm laminate.				
6.6	PAINTING PLASTIC PAINT	Sq.Ft.	0.00		
	Applying 2 Coat putty with primer and Providing and applying Plastic emulsion paint (asian) of approved make and shade on walls including scrapping off, preparing the base & applying 3 or more coats of approved make, color and shade to give an even and smooth surface on new work including necessary scaffolding, coat of cement primer etc. all complete as per direction of Bank. (only banking hall.)				
6.7		Sq.Ft.	0.00		
	Applying 2 coat of Plastic emulsion paint (asian) of approved make and shade on walls including scrapping off, preparing the base ect color and shade to give an even and smooth surface on new work including necessary scaffolding, coat of cement primer etc. all complete as per direction of Bank. (Other than banking hall.)				
6.8	ROLLING BLINDS	Sq.Ft.	60.00		
	Providing and fixing Roller blinds of approved design and shade by the Architect,incl all std fittings as per manufacturer's specification. The work to be completed as per specification and approval of the architect. (approved brand Vista, Hunter Dogulus)				
	GRAND TOTAL FOR FURNISHING (A)			Rs	
	* GST EXTRA AS APPLICABLE				



BILL OF QUANTITY FOR ELECTRICAL WORKS

FOR REFURNISHING OF UP GRAMIN BANK BRANCH AT GARAUTHA-JHANSI

S.No.	Particulars	Unit	Qty.	Rate	Amount
1	Supply, laying, connection & testing of light, fan point, wiring by 2x1.5mmsq(2x3/.029) +1x1mmsq PVC insulated, multistrand single core copper conductor FRLS wire maintaining the colour code as per direction in PVC conduit of 20mm with ISI mark 1.5mm thickness to conceal in wall partition mending good the damage, complete with PVC circular box, bend to be done as per drawing including 3 point ceiling rows wherever required GI saddle to be used for fixing, metal flexible/PVC flexible pipe may use if required in partition wall. All PVC pipes should be with ISI mark. No joints will be allowed inside pipe, light, fan & plug point complete with modular type switch plate & MS box. rate including the main circuit line 2x2.5mmsq+1x1.5mmsq earth PVC insulated Cu. Wire from DB to switch board, maintaining the colour code. Circuit line for lighting switch board & 6Amps plug board are to be drawn from lighting DB to Lighting board & plug point board (independent), 6/16 Amps plug point line are to be draw from power DB. as per DB schedule /SLD.				
a)	1 light by 1 switch				
b)	2 light by 1 switch	Nos.	41		
c)	3 light by 1 switch	Nos.	17		
e)	Ceiling fan point with step type electronic regulator	Nos.	0		
f)	Same as above, but for exhaust fan excluding regulator.	No	6.00		
g)	Same as above 5A Point in the switchboard itself.	No	3.00		
h)	same as above Wiring for call-bell point including buzzer	No	10.00		
i)	Wiring (2x2.5mmsq+1x1.5mmsq from power DBs) for independent 6A multi pin socket at walls along with 6A modular type switches board housed in painted MS box (upto 3 independent plug points can be taken in one circuit). For wall Fan	No	9.00		
1.2	Supply and installation of modular type 2 nos 6A & multi pin sockets with 2 nos 6 Amp one way switch housed in MS box to be fixed in partitions or concealed in wall. The box shall be painted with 2 coats of enamel paint over a coat of red oxide primer including wiring for Raw power socket outlet, using 2 R runs of 2.50 Sqmm and single run of 1.5 sqmm PVC insulated multi stranded single core copper conductor FRLS wire in 20mm PVC conduit to be laid in floor, partitions, etc. complete with all accessories (looping 2 sets of 2x6A socket outlet in one circuit- from DB)	No	7		
1.3	Supply and installation modular type 16A, 5-pin socket with 16A one way switch housed in MS box to be fixed in partitions or concealed in wall. The box shall be painted with 2 coats of enamel paint over a coat of red oxide primer, the rate shall include wiring fusing 2R 4.0 sqmm & single run of 2.5 sqmm PVC insulated multi stranded single core copper conductor FRLS wire in 25mm PVC conduit to be laid in floor, partitions, etc complete with all accessories (for line printer : or optional). (upto 2 independent plug points can be taken in one circuit)	Each	9		
B - AIR CONDITIONING					
1	AC POWER PLUG POINT Supply and Installation of 15A modular type socket separately controlled by 32A Modular type DP indicator switch with suitable metallic box for the local control of the Split AC including Wiring using 2x4Sq.mm along with 1x2.5 Sq.mm pvc insulated copper wire through 20mm PVC (ISI- H) conduit.	Job	5		
C - UPS					



1	S/Laying of 4 core 10 sq.mm PVC armoured Aluminium conductor cable from main Panel to 4way TPN Db in the UPS room to be laid in 25/32mm heavy duty PVC conduit/ pipe & run on surface or concealed in wall/ floor/ false ceiling. (Finolex/Skytone/ Cable corpn.)	m	14		
2	Supply & fixing flush type Single door IP20 4way TPN distribution board for regulating UPS supply complete with 63A TP MCB as incomer & 2nos. 32A DP MCB as outgoing (Assumed 2nos. 5Kva UPS - one Hot & one Sb.)	Each	1		
3	Supply & laying of incoming & outgoing wiring to & from UPS with 2x 4.0sq.mm + 1x 1.5sq.mm (earthing) stranded Cu. wire conductor (Finolex/Anchor/Skytone) to be laid in 20/25 mm flexible PVC pipe heavy duty to UPS incoming & from UPS outgoing to DP MCB in 16way SPN Db.	m	8		
4	Supply & fixing of 12way SPN Db flush type single door IP 20 - MDS/ Hagers/ Siemens complete as under	Each	1		
	Incoming - 32A DP MCB - 1Nos.				
	6Nos. - SP 6/10A MCB of 10ka rating (MDS/ Hagers/ Siemens/ ABB)				
5	Supply & fixing of 4nos. 6A switches & sockets (Modular)complete with computer point circuit wiring with 2x2.5sq.mm + 1x 1sq.mm stranded Cu. Single core Copper conductor (Finolex/Anchor/RPG) to be laid in 19mm M S conduit pipe heavy duty 16swg or 1" PVC casing capping vertical drops heavy duty laid & concealed in wall/ floor/ panelling/ partitions or above false ceiling as per requirement. 2 Nodes per circuit	Per Node	9		
	D - DISTRIBUTION MAINS				
1	S/F of 3 nos. 100Amps Kit kat set link type with heavy duty neutral link and making its connection from electronic meter c/w wooden board etc.	Set	1		
2	MAIN ELECTRICAL DISTRIBUTION				
	Main Panel (wall Mounted Type)				
	Supply, fabricating,assembling,internal- connection, testing & connecting with incomming, out going power cables & lines as required to complete the job of cubical type electrical panel made from 14SWG CRC. M.S. sheet with proper earthing terminal(Nut-bolt &washer) 02 No.outside of panel, same nut- bolt to tighten with internal earth busbar of panel situated inside loose wire box(on top portion of panel) On top side of panel cable entry arrangement to be done for incomming & out going of lines. Painting powder coating electrical grey/ seimensgrey to be done.one 6"x4" enamel type 440Volt Danger board to fix up on main panel bus-bar cover, components are as follows :-All switches are front handle operated & all MCB knob should be visual, all component to provide in separate compartment only DBs in one compartment.				
	Incomer - 100A 4P MCCB 25Ka with adjustable thermal & Magnetic trip unit -1 Nos				
	OUTGOINGS -				
	63 Amps 4 pole MCB. = 04 Nos.(AC & Power DB,ATM ,UPS,spare)				
	40 Amp 4 Pole MCB :2 nos (Lighting DB,Spare)				
	25 Amps DP MCB = 02 Nos.(sign board , Fire Alarm)				
	Amps Meter 0-100 Amps with 3 Nos. CT & selector switch 96x96mm				
	01 Set (Changeover should be ON-LOAD type.)				
	100Amps 4pole Cu. Bus Bar. 01 Set.				
	100Amps 4 pole Change over switch. 01 No.				
	100 Amps FP MCCB 25KA as Gen - Set main incoming 01 NO.				
	Volt meter 0-500volt A.C. 50 Hz.96x96mm with selector switch. AE make.n				
	01 Set				
	20mmdia LED indicator lamp	03 Nos.			
	02 Amps Sliding Fuse.	06 Set.			
	150x100mm enamel Danger board 440 volt.				



	(to set on bus bar cover).	01 No.			
	Cable entry from top & bottom - removable gland plates (bottom at 2 points) c/w powder coated Grey paint (two coats) with name labels for all incoming & outgoing feeders. The panel shall be complete in all respects including all accessories such as earthing bus, Air ventilators, lifting hooks etc.	Set	1		
2	LAYING OF CABLE :				
2.1	Supply laying fixing main power with 50mm sq 3.5 core PVC insulated,PVC sheated Alu.Conductor, 1100 v. grade armoured cable complete with 02 nos 8 SWG bear GI.wire as running earth .(Mts.	15		
2.2	End termination of 50mmsq 3.5 Core armoured cable,complete with brass cable gland , Alu. Lug, PVC tape.	Nos	10		
2.3	- Do - 3.5 x 16 sqmm with 02 nos 8 SWG bear GI.wire as running earth. for Light D.B	Mts	25		
2.4	- Do - 3.5 x 25 sqmmth with 02 nos 8 SWG bear GI.wire as running earth. for POWER & A.C D.B , UPS & ATM	Mts	20		
2.5	- Do - termination of 25 & 16 Sqmm 3.5 Core	Nos	8		
5	LIGHT DB				
A	Supply, installtion, testing & commissioning of flush mounted 4way TPN distribution boards double door IP -42 for PP complete in all respects as under - Siemens/ MDS/ Hagers	Each	1		
	Incomer - 63A TP MCB 10 KA Rating - (Siemens/ MDS/ Hagers/ Schnider) neutral to be directly connected to neutral bus				
	Outgoing				
	R - 16/ 16/16A				
	Y - 16/ 16A				
	B - 16/ 16A				
	Blanking Plates - 5nos.				
B	AC DB : Supply, Installation, testing and commissioning of wheather proof 4 Way double door TPN DB of approved make with all necessary inter connections consisting of the following for AC load. Each terminals on MCB should be connected with Aluminium Leg				
	Incoming : 63A 4P RCCB (300mA) -1 No.				
	Outgoings: 20 A SP MCB -2Nos. (1TR AC)				
	32 A SP MCB -4Nos. (1.5TR AC)	Each	1		
3	Out door type glow sign board wiring :-				
3.1	Supply laying of main line with 2x2.5 +1x1.5 mmsq through MS conduite from main panal to glow sign board.	Mts	15		
3.2	Supply installation of 16 amps DP MCB at main entrance Glow sign board & With Electronic timer as required.	Set	1		
	F- EARTHING				
1	S/burying of 600 x 600 x 3mm Cu. Plate Vertically for earthing, with its top at least 3m below GL complete with 20mm GI pipe & funnel for watering & one earthing lead of 25x3 mm Copper strip (Assumed length of 10m - beyond 10m to be paid extra) in 32mm dia. G.I. Pipe upto switch board/Main Db, 300mm square CI frame with hinged cover, masonry housing, alternate layers of charcoal/coke & salt at least 150mm thick all around complete in all respects with guaranteed earth resistance to be ensured 1 Ohm in all cases. The 25x3mm Copper strip shall be terminated on a separate 6way earthlink for UPS. The connections for Panel earthing & earth bus in the panel should be taken from this earthlink. (1for power system &1 for UPS). The distance between two earthing pits to be 10ft or more.	Job	2		



2	Supplying, laying & fixing of 10 sq mm. copper pvc insulated wire covered with GI pipes from earthing plate to main panel.if required beyond 10m	Per M.	20		
G - SUPPLY & FIXING ITEMS					
1.0	Supply and Installation Recess mounted 2'-0"X2'-0" watt ,38 W LED FULL GLOW Philips MAKE . Light should be fixed through SS threaded bolt tighted the upper end on ceiling using anchor bolt and lower end on Light fitting with nut and bolt (RC380B G2 LED35S-6500/4000 PSU OD WH) PHILIPS/WIPRO MAKE	Nos.	25		
2.0	SQUARE SHAPE DOWNLIGHTER - INTEGRA 15W, 3000K, LHEBGTP5Z1W015, PHILIPS Razor/WIPRO MAKE	Nos.	35		
3	S/F 4ft 20 w Led Tube light fitting - Phillips ,WIPRO make approved by Bank/ Architect	Each	13		
4	S/F of angle holder for bulbs including cost of 15 w led lamp	Each	3		
5	S/F of steel body wall mounted fan 450mm sweep -Bajaj/ Crompton/ Alsthom	Each	9		
6	Supplying & Fixing 1200mm dia Ceiling Fans usha Model Senator Max colour specified by the bank with all necessary fitting like U hook,Rod for hanging, length as/site required.	Each	6		
7	Supply & Fixing of Exhaust fresh air fan 300mm - Crompton Greaves/ Usha/ Khaitan/ Bajaj	Each	3		
Total Cost of works				Rs-	-
* GST EXTRA AS APPLICABLE					
Note - 1) All electrical items body earthing connections to be made properly & checked throughly.					
2) All cable connections to be properly terminated thru lugs.					
LIST OF APPROVED MAKES/ BRANDS					
S. No	Description	Approved make			
1	Electrical Fittings	Philips/Wipro/havils/crompton			
2	Electrical Switches	MK India/ North West			
3	Electrical Conduits(FLRS)	Setia/ AKG			
4	Fans	Crompton/ Equivalent			
5	Electrical Wiring(FLRS)	Anchor/ Skytone/ Finolex			
Note					
1	Any Other materials to be Got Approved by the Architect				
2	In General CPWD & IS Specifications to be followed				



**DETAILED SPECIFICATIONS & ESTIMATE
FOR UP GRAMIN BANK BRANCH AT GARAUTHA-JHANSI**

A	DATA CABLING WORK				
S.No.	DESCRIPTION	QTY	UNIT	RATE (In Rs)	TOTAL (In Rs)
2.2	Wiring for computer networking from I/O hub to computer workstation with UTP Cat-6 computer cable including providing ferrules at both ends and termination at both ends including providing & fixing frame for with shutter, RJ 45 outlet, faceplate and mounting box complete of modular type, This work includes providing PVC conduits (1/2", 3/4" size or as required) in chases from the I/O hub to the point. The cost includes testing, commissioning etc complete. Note : Do not run more than 3 wire in single pipe & should be concealed	Nos.	9		
2.3	Supply of Cat - 6 D-Link patch cord 7' 0"	Nos.	9		
2.4	Supply of Cat - 6 D-Link patch cord 3' 0"	Nos.	9		
2.5	Supply & fixing 24 Port Jack Panel Make:-D-Link	Nos.	1		
2.6	9U Rack with Glass Door, Locking system Make: APW	Nos.	1		
2.7	24PORT 10/100Mbps Switch	Nos.	0		
GRAND TOTAL FOR LAN & TELEPHONE (C)				RS	0
* GST EXTRA AS APPLICABLE					



D- AIR CONDITIONING WORK

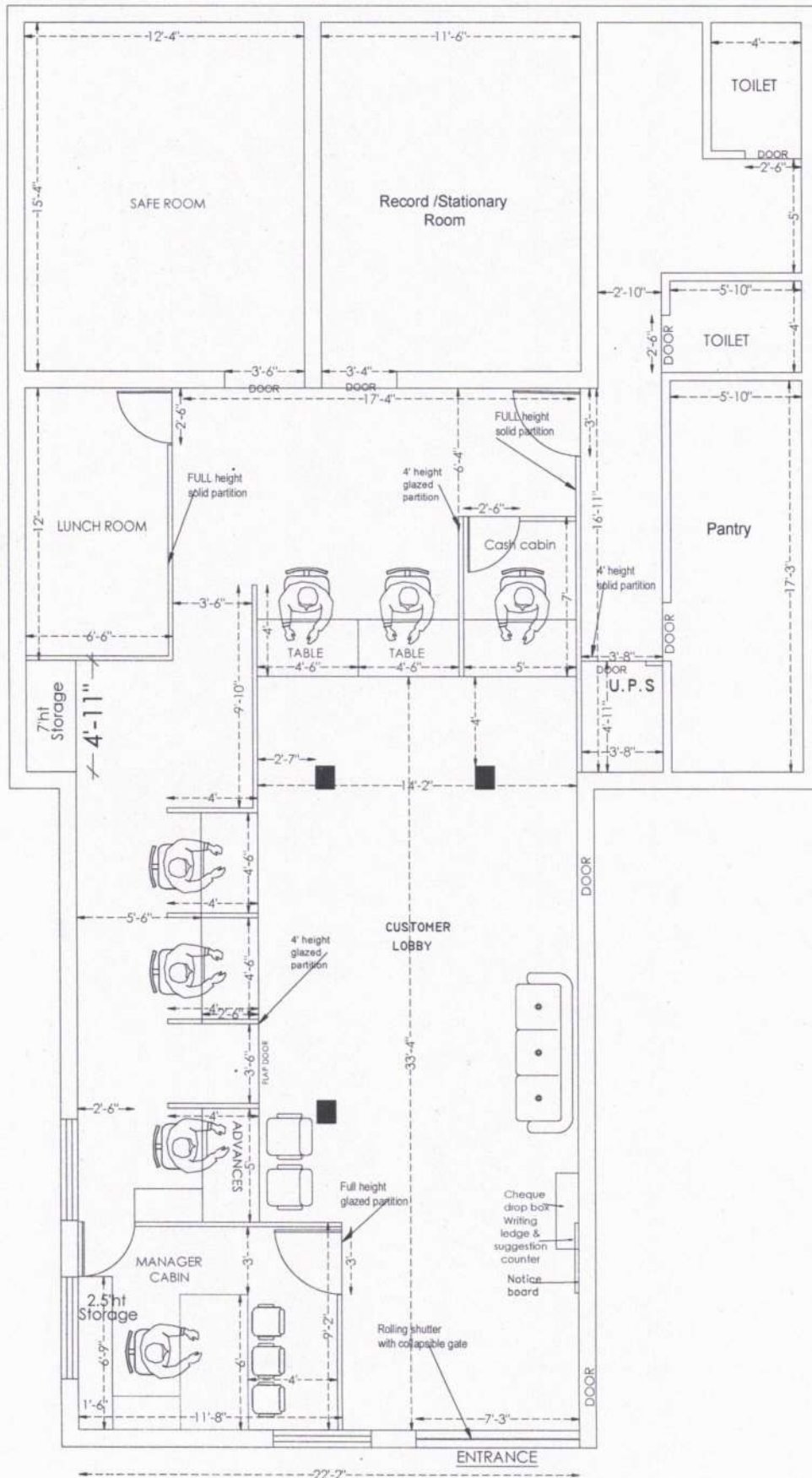

PROJECT
PROPOSED FURNITURE LAYOUT OF UP GRAMIN BANK GARAUTIA A T
BHANSI

DRAWING
LAYOUT

NORTH

SCALE N.T.S.
DATE
SEP. 2025

ARCHITECT
MOHIT & ASSOCIATES
ARCHITECTS, INTERIORS, ESTIMATORS
1-2/554 VINEET KHAND, GOMTI NAGAR,
LUCKNOW, MO. - 9582218092, 7428217639



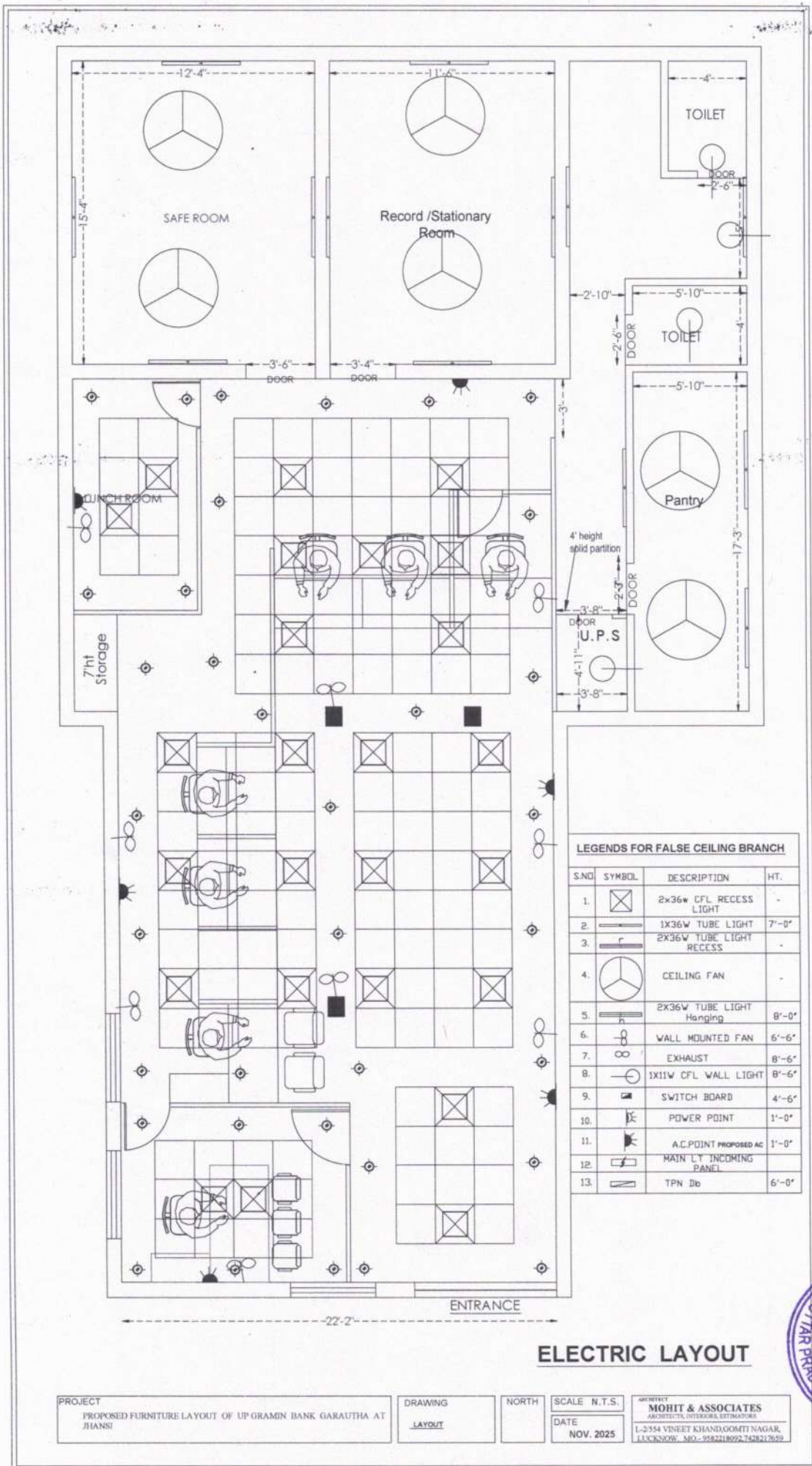

ELECTRIC LAYOUT

PROJECT
PROPOSED FURNITURE LAYOUT OF UP GRAMIN BANK GARAUTHA AT JHANSI

DRAWING
LAYOUT

NORTH

SCALE N.T.S.
DATE
NOV. 2025

ARCHITECT
MOHIT & ASSOCIATES
ARCHITECTS, INTERIORS, LITMAYORI
L-2/554 VINEET KHAND, GOMTI NAGAR,
LUCKNOW, MO. - 958218092, 7428217659



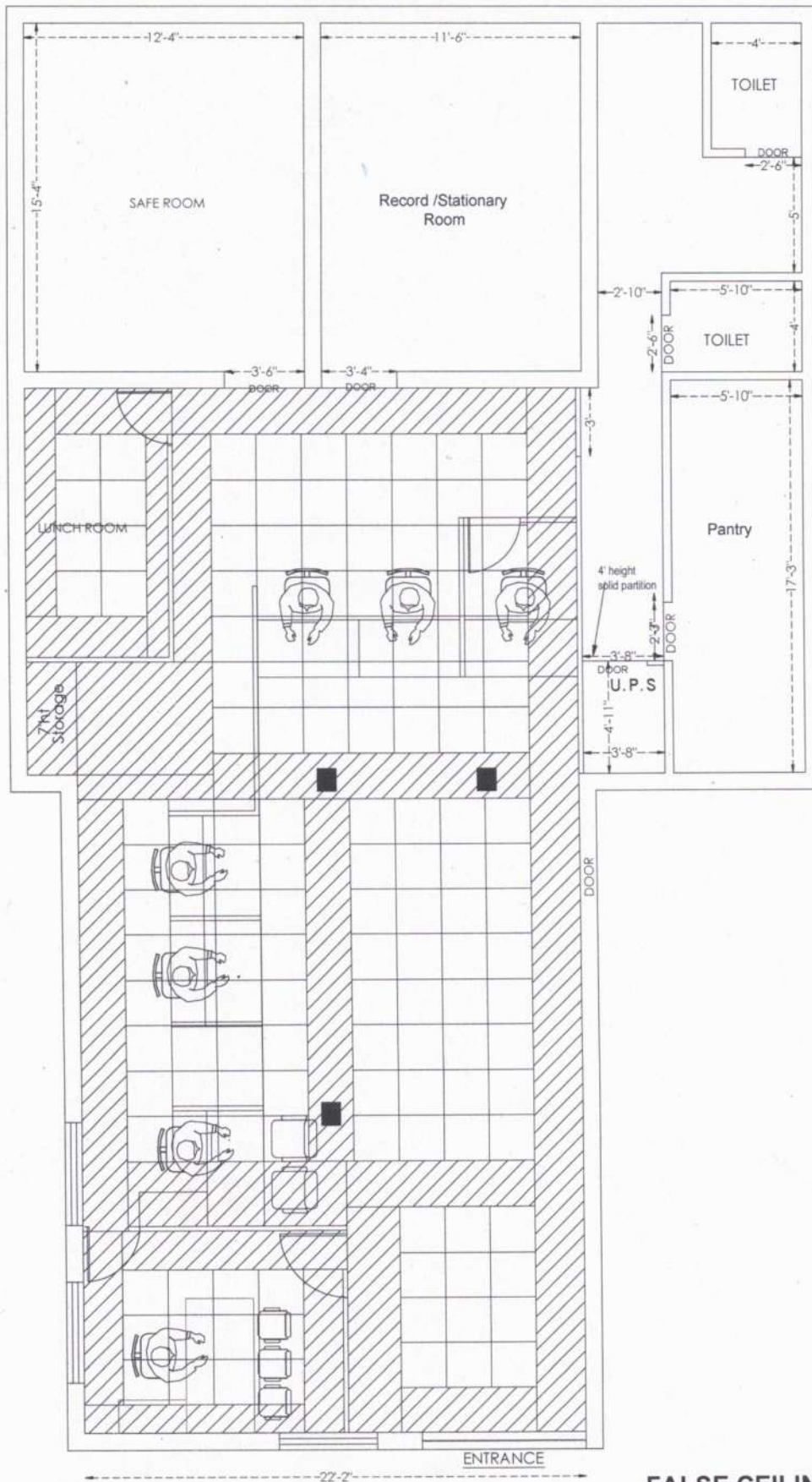

FALSE CEILING LAYOUT

PROJECT
PROPOSED FURNITURE LAYOUT OF UP GRAMIN BANK GARAUTIA AT
JHANSI

DRAWING
LAYOUT

NORTH

SCALE N.T.S.
DATE
NOV. 2025

ARCHITECT
MOHIT & ASSOCIATES
ARCHITECTS, INTERIORS, ESTIMATORS
L-2/554 VINEET KHAND, GOMTI NAGAR,
LUCKNOW, MO. - 9582218092, 7428217659

