



उत्तर प्रदेश ग्रामीण बैंक UTTAR PRADESH GRAMIN BANK

(सरकार के स्वामित्वाधीन अनुसूचित बैंक)
(Scheduled Bank Owned by Government)

Ref-ROBALL/P&E/2025-26/154

Date - 09-12-2025

Tender for furnishing and electrical works of BAHUARA Branch, Region - Ballia -1

Uttar Pradesh Gramin Bank Regional Office, ballia-1, LM VIP lodge Tikhampur invites seal tender for furnishing and electrical works for our Branch at BAHUARA, District - Ballia from the empaneled furnishers of Uttar Pradesh Gramin Bank Head Office, 2nd and 3rd floor, NBCC Commercial Complex, Vardan khand, Gomti Nagar Extension Lucknow 226010

- | | | |
|--------------------------------------|---|-------------------------|
| 1. Tender Issuing Date | : | 09-12-2025 |
| 2. Last Date Of Submission Of Tender | : | 30-12-2025 Upto 05:00PM |
| 3. Date Of Opening Of Tender | : | 31-12-2025 |
| 4. Tender to be address to | : | |

The Regional Manager
Uttar Pradesh Gramin Bank
Regional Office-Ballia I
LM VIP lodge Tikhampur
near Krishi mandi
Ballia - 277001 (UP)

Terms & Condition of tender:

- Rates should be quoted on the space provided in the annexure attached only. No other sheet/form should be used for quoting rates.
- Rates quoted only by Bank's empanelled Vendor will be consider/accepted.
- The competent Authority (Bank) does not bind themselves to accept the lowest or to give any reasons for its decision of acceptance or rejection of tenders.
- Incomplete in any respect or conditional tender shall liable to be rejected.

Other Conditions:

- The registration number of the along with GST no. allowed by the authorities must be submitted.
- PAN Number of the firm allotted by the income tax authorities should be submitted (without which the vendor's bid would become invalid and shall be liable to be reject).
- Conditional tenders shall not be accepted on any ground and shall be rejected straight.
- Any deviation of the conditions given by the purchaser will not be accepted and bid will be rejected without assigning any reasons.
- If any clarification is required the same should be obtained before submitting the bid.
- The Entire document must be signed with the seal and attached as a mark of acceptance of the terms & conditions.
- UPGB reserve the right to accept or reject any bid whole or in parts without assigning any reason thereof.
- Bank's decision will be final and no correspondence will be entertained in this regard.
- In case of delay in submission/non-submission of bids, Bank will not assume any responsibility.
- Bank may reject any or all quotations without assigning any reason.

क्षेत्रीय कार्यालय बलिया-1 :- एन.एम. वी. वार्ड, पी.लॉज निकट कृषि मंडी परिक्षरा- बलिया - 277001
Regional Office Ballia-1 :- L.M.V.I.P Lodge Near Krishi Mandi Parikhara Ballia-1 - 277001
e-mail : ROBALL@barodauprb.co.in Website: www.barodaupbank.in



उत्तर प्रदेश ग्रामीण बैंक
UTTAR PRADESH GRAMIN BANK

(सरकार के स्वामित्ववादी अनुसूचित बैंक)
(Scheduled Bank Owned by Government)

Tender Submission:

Submission of tender in sealed envelope super scribing "TENDERS FOR FURNISHING AND ELECTRICAL WORKS OF BAHUARA BRANCH, DISTRICT -BALLIA" addressed to Uttar Pradesh Gramin Bank Regional Office Ballia 1 L.M.V.I.P. Lodge Near krishi mandi ballia-277001 Complete in all respect by 05:00PM

dated **30-12-2025**. Tenders received after shall not be entertained.

Tender must be submitted through hand to hand or through register post only.

Evaluation Of Tender:

Quoting incredibly low value of items with the view of subverting the tender process shall be rejected straight away.

Yours faithfully,

(Vinod Kumar Misra)

Regional Manager

Uttar Pradesh Gramin Bank

Regional Office-Ballia-1

Enclosure-Tender documents for interior Furnishing, Electrical work & data work for Branch
BAHUARA



उत्तर प्रदेश ग्रामीण बैंक
UTTAR PRADESH GRAMIN BANK

(सरकार के स्वामित्वाधीन अनुसूचित बैंक)
(Scheduled Bank Owned by Government)

ARCHITECTS

Vision Arch
Sh. 2/51, D-7-M, Prince Cyber Café
Building, Near Meerapur basahi
Crossing, Varanasi
varch0036@gmail.com
8957906861, 9450165944



NOTE-FOR FURNITURE WORK ONLY BANK'S EMPANELED CONTRACTOR'S CAN PARTICIPATE IN THIS TENDER.

IMPORTANT SCHEDULES

DATE OF ISSUE OF TENDER	: 08-12-2025
LAST DATE OF RECEIT OF TENDER:	30-12-2025 till 17:00hrs
DATE OF OPENING OF TENDER	: 31-12-2025
SIGNING OF AGREEMENT	: Within 2 days of issue of letter of intent/ order
COMMENCEMENT OF WORK:	Within 5 days of issue of letter of intent/ order
PERIOD OF COMPLETION	: 20 days from the date of issue of letter of Intent / order
LIQUIDATED DAMAGES	:RS 5,000 per week, subject to a max. of 7.5% Of the accepted Contract Sum.
PERIOD OF RUNNING BILL	: Fortnightly
RETENTION MONEY/DEPOSIT	: 5 % of Gross Value from Each running Bill
REFUND OF SECURITY &RETENTION DEPOSIT	: a) Initial Security Deposit- to be released within 14 days of requesting the bank after obtaining the Certificate of Completion. b) Retention Money – to be refunded 14 days after giving in writing a request after End of Defects Liability Period.
INCOME TAX DEDUCTION	: At the Prevailing Rates from each bill
DEFECTS LIABILITY PERIOD	: 12 months after completion of Works
PERIOD OF FINAL MEASUREMENT	: 3 weeks from completion/ date of submission of Final Bill, whichever is later.



उत्तर प्रदेश ग्रामीण बैंक
UTTAR PRADESH GRAMIN BANK

(सरकार के स्वामित्वाधीन अनुसूचित बैंक)
(Scheduled Bank Owned by Government)

SECTION – I

INVITATION TO TENDERERS



SECTION- I

1.1 Sealed tenders on item rate basis are invited in the prescribed form by the Uttar Pradesh Gramin Bank, Regional Office, BALLIA-1

Tender No.	Name of Work	Time of Completion
CON/BUP/FURNISH/_BAHUARA	Furnishing, Electrical work of Branch- BAHUARA	20 days

1.2 The work as detailed in this tender shall be executed and completed in all respects within the stipulated period in accordance with the Tender Document, Bill of Quantities, Drawings and Instructions, to the satisfaction of the Architects and the Employers.

1.3 Tenders filled in the prescribed form should reach the office of RM, Uttar Pradesh Gramin Bank latest by Date – 30-12-2025, 17:00 hrs. in sealed covers and super scribed with the name of the work and the tender No. They would be opened on 31-12-2025 in the presence of Bank officers.

1.4 Rate must be quoted for complete work at site inclusive of all costs, charges, taxes etc but excluding GST on WCT. All duties ,E.S.I. charges etc. as applicable at UP central or state sales Tax, Octroi, Royalties etc. on works and materials required for use in the execution of this project shall be entirely borne and payable by the contractor and the Employer will not entertain any claim whatsoever in this respect except GST on WCT.

1.5 The tenders shall remain valid for acceptance by the Employer for a period of 3 months from the date of opening the tenders.

1.6 The Security amount and The Retention Money will be refunded without any interest. As per the schedule mentioned.

1.7 The Defects liability period will be 12 months from the date of completion of Work. Any defects found during this period in the various jobs executed by the contractor will have to be rectified by him, without any extra charges. In case the Employer finds that the contractor has not carried out the rectification, then he is at a liberty to get the same executed by another contractor and adjust the amount spend from the Security Deposit of the main contractor.

1.8 The earnest money of the successful tenderers will be forfeited in the event of his refusal/ delay in starting the work. The Decision of RM, Uttar Pradesh Gramin Bank will be final in this.

1.9 Tender documents (complete) duly filled and signed by the tenderers shall be submitted as the tender for the work.

1.10 The Uttar Pradesh Gramin Bank and the Architects, Vision Arch do not bind themselves to accept the lowest or any tender, or to assign any reason thereof and also reserves the right of accepting the whole or part



of the tender. The tenderers in such an event will be bound to perform the contract at the same rates as quoted in the tender for various works. Any item is liable for alteration at the discretion of the Architect & the Employer, if required.

1.11 Canvassing in any form in connection with the tender is strictly prohibited and the tenders submitted by the contractor who resorts to canvassing in any form will be liable for rejection.

1.12 The tendering firms, in case the tenderers is a partnership firm, shall submit the tender signed by all the partners.

1.13 On acceptance of the Tender, the Contractor shall intimate the name of his accredited representative who would be responsible for taking instructions from the architects and carrying out the works.

1.14 The successful tenderers will extend full co-operation with other contractors appointed by the employer, so that the work shall proceed smoothly. The main responsibility of the overall completion of the work in time will lie with the Furnishing Contractor.

1.15 The successful tenderers will need to sign the agreement, three sets, on stamp paper of Rs 100/- only. Tenderers failure to make such an agreement within the stipulated timeframe will amount to non- acceptance on his part. In this case the Employer will have the right to revoke the acceptance of tender without any further notice to the tenderers.



उत्तर प्रदेश ग्रामीण बैंक
UTTAR PRADESH GRAMIN BANK

(सरकार के स्वामित्वाधीन अनुसूचित बैंक)
(Scheduled Bank Owned by Government)

SECTION – II

INSTRUCTIONS TO TENDERERS



SECTION _ II

2.1 The tenderers are advised to visit and inspect the site at his own cost and responsibility and to secure all necessary information which may be required for completing the tender. Ignorance of site conditions or local information shall not be considered as an excuse for non- performance of the contract or any increase in the rates quoted by him.

2.2 The tenderers shall examine carefully all the tender documents consisting of :

- Invitation to Tenderers
- Instructions to Tenderers
- General and Special Conditions of Contract
- Bill of Quantities
- Set of Drawings

All the above shall form Part of the agreement.

2.3 Time is the essence of contract and the tenderers are required to complete the works in all respects to the satisfaction of the Architect & the Employer within the stipulated time.

2.4 The tender should contain the rates & the amount (both in figures and words), in the prescribed column of the BOQ. All the items should be totaled up in the end. All corrections should be duly attested by the tenderers. In case of any discrepancy between rates and amounts, the lower value will be taken for the finalizing of the tender amount.

2.5 It shall be clearly understood that the rates quoted in the tender are to be, for complete work at site, as per the instructions to Tenderers, Conditions of Contracts, Specifications and Drawings and also for all such works as become necessary for proper completion of works, although specific mention thereof may not have been made in the specifications or drawings of tender documents. The rates shall be firm and not subject to cost escalation on account of labor and material conditions or any other reason whatsoever.

2.6 The tenderers shall use only the form issued with this tender to fill up the rates.

2.7 Every page of the tender shall be signed on the left hand side bottom corner as a token of acceptance.

2.8 The Contract will be governed by the Indian Contract Act, Indian Sale of Goods Act and all other relevant Laws. All payments due to the contractor under the contract will be made in Indian Rupees Currency.



उत्तर प्रदेश ग्रामीण बैंक
UTTAR PRADESH GRAMIN BANK

(सरकार के स्वामित्वाधीन अनुसूचित बैंक)
(Scheduled Bank Owned by Government)

SECTION –III

FORWARDING LETTER



उत्तर प्रदेश ग्रामीण बैंक
UTTAR PRADESH GRAMIN BANK

(सरकार के स्वामित्वाधीन अनुसूचित बैंक)
(Scheduled Bank Owned by Government)

FROM -----

TO, RM
Uttar Pradesh Gramin Bank
Regional Office
BALLIA-1
Ref: Tender No.CON/BUP/ BAHUARA /FURN

Dear Sir,

With reference to the tender invited by you, I/we hereby offer to perform, provide, execute and complete the works in conformity with conditions of contract, drawings and specifications for the respective items of schedule of quantities attached hereto.

I/we have satisfied ourselves as to the location and prevailing conditions of the site, and have read carefully the Articles of Agreement, Conditions of Contract, Specifications, General and Special Conditions, Technical Specifications, etc. I/we understand that the works are to be completed within ----days from the date of issue of letter of Intent/ Order and fully understand that time will be the essence of the contract.

Should this tender be accepted in whole or part, I/we hereby agree to abide by and fulfill all the terms and conditions annexed hereto.

All the terms and conditions of tender have been fully read by me/us. I/we accept the same and sign hereunder in token of their acceptance.

We further enclose the following documents:-

- i) Proprietorship registration, Partnership deed, Article of Association and Power of Attorney, as applicable. We agree that no change will be made in these documents without prior approval of Baroda UP Bank
- ii) Tender document Duly signed.
- iii) Details of my firm
- iv) Latest 3 years ITR

Name of Proprietor/Partners/ Directors

Yours Faithfully

Signature of Tenderers with
Official Stamp.
Date:



उत्तर प्रदेश ग्रामीण बैंक
UTTAR PRADESH GRAMIN BANK

(सरकार के स्वामित्वाधीन अनुसूचित बैंक)
(Scheduled Bank Owned by Government)

SECTION –IV

GENERAL CONDITIONS OF CONTRACT



SECTION IV

4.1 DEFINATIONS

In this contract, the following words and expression shall have the meaning thereby assigned to them unless the contract ascribed a different meaning

- a) Employer means Uttar Pradesh Gramin Bank and includes their authorized representatives to deal with any matter on their behalf.
- b) Employer- in – charge means the person appointed by the Employer and notified to the Contractor to be in charge of the project
- c) Clerk of Works means any Engineer appointed by the Employer to perform the duties of Resident Engineer, limited to Supervision of Work and notified to the Contractor to be in charge of the project
- d) Architects means the Architects Employed by Uttar Pradesh Gramin Bank to give consultancy.
- a) Contractor means the individual, firm or Company with whom the contract is entered into and includes the heirs, executors, or successors.
- b) The expression Contract means the document forming the Tender and acceptance thereof and included all the sections of the tender including BOQ and set of drawings.
- c) Tender means the offer made by an individual or firm or company for execution of the works.
- d) Acceptance of Tender means the letter from the Employer communicating to the tenderer the acceptance of this tender and include the advance acceptance of his tender.
- e) Drawings means the drawings referred to in the tender documents including any modifications of such drawings approved in writing by the Architect or his representative and such other drawings as are made from time to time and furnished by the contractor and approved by the Architect.
- f) Site means the actual lace as described in the tender at which the execution of works is to be done with the surrounding areas.
- g) A Week shall mean 7 days without regard to the number of Hrs worked in a day in that week.
- h) Specifications means standard specifications for works and materials brought out in the tender, and added to or superseded by special specifications. In absence of any specifications for any item of work the relevant specifications in CPWD or IBA works Manual shall be followed and work be executed accordingly.



4.2.1 EXTENT OF CONTRACT

The contractor shall supply at his own cost all the materials like ladders, scaffoldings, temporary works that may be required for the proper execution of the works, whether original, altered or substituted works. The contractor shall also supply survey instruments and other materials necessary for purpose of setting out of works and assisting to the measurements or examination at any time.

The contractor shall also provide a sufficient portion of fencing and lights required to protect the public from accidents and shall be bound to bear any expenses of defense brought by any person for injury sustained owing to neglect of the above precautions, and to pay any damages and costs which may be awarded in any such suit, action or proceedings to any such person. In no case the Employer shall be a party to any such claim and the Contractor shall indemnify the Employer against any claim for any person on this account.

4.2.2 Sufficiency of Tender

The Contractor shall be deemed to have satisfied himself before tendering as to the correctness and sufficiency of his tender for the works and his prices for the work which shall cover all his obligations under the Contract and all matters and things necessary for the proper completion and maintenance of the work.

4.2.3 Sub- Letting of Contract

The contractor shall not assign the contract or any part thereof to any other party without the prior written consent of the Employer.

4.2.4 Power to Make alterations

Architect shall have the powers to make any alterations or additions to the stipulated specifications, drawings, designs and instructions that he may feel necessary or advisable during the progress of the work. The contractor shall have no claim for compensation on account of such alterations or additions. The contractor shall be bound to carry out the work in accordance with any instructions which may be given to him in writing signed by the Architect and such alterations shall not invalidate the Contract, and any additional work which the Contractor may be directed to do in the manner above specified as part of the work shall be carried out by the contractor.

The time for completion and Costs of such additional works shall be extended in proportion to the original contract. The certificate of the Architect shall be conclusive as to such proportions.

4.2.5 Works subject to approval of Architect

All works to be executed under the contract shall be subject to approval of the Architect who shall be entitled to direct at what points and in what manner they are to be commenced.



4.2.6 Urgent repairs and Urgent Works

If by any reason, during the execution of the work or during the defects liability period, any works or repair become urgently necessary and the Contractor is unable / unwilling to do such work immediately, then the Employer may get the same done on their own and deduct the cost thus incurred from the funds due to the contractor.

4.2.7 Clearance of Site

The Contractor shall have to remove all Malba from site of work, dirt and dust, etc. before handing over the works to the Employer. The works shall not be treated as complete in all respects unless these requirements are fulfilled.

In the event the Contractor failing to do so the architect and the employer shall have the right to get the site cleared at the contractors risk and cost.

4.2.8 Protection of Trees and Shrubs

Trees and Shrubs designated by the Architect shall be protected from damage during course of the work and the earth level shall not be changed within three feet of such trees.

4.3 ARCHITECTS STATUS AND DECISIONS

- a) The Architect shall have General supervision & direction of Works. He has authority on behalf of the Employer to stop the work whenever such stoppage may be necessary to ensure proper execution of the works. The Architect shall be the interpreter of the conditions of Contract and the judge of its performance.
- b) The Architect within reasonable time make decisions of all claims of the contractor and all other matters related to the execution and progress of work.

The decision of the Architect with respect to all or any of the following matters shall be final

- i) Variation/ Modification of the Design
- ii) Quality and Quantities of Works Executed
- iii) Discrepancies in the drawings and Specifications
- iv) Opening up for inspection of any work covered up.
- v) Amending of any defects occurring under Defects Liability Period

- c) The Contractor shall on the report of the Architect immediately dismiss from the works within 24 hrs any person employed thereof by him who may in the Opinion of the Architect/ Employer be incompetent/ misconducts himself.



4.4 DIRECTIONS REGARDING DRAWINGS & DESIGN

- a) After signing the Contract, the Contractor will be given three sets of drawings free of charge. Additional copies if required would be made at his own costs. One set of the drawings shall be kept at the site by the contractor and available to Architect/ his representative at all times.
- b) Further drawings and Instructions including revisions, as the Architect may furnish to the contractor shall form part of this contract.
- c) Only figured dimensions and detailed drawings shall be followed. The Contractor shall verify all dimensions in the field before any work is Commenced and obtain instructions of the Architect in case of any discrepancy.

4.4.2 Action where no specifications

In case of any work for which there are no specifications in the contract, such works shall be carried out in accordance with the directions of the Architect.

4.5 DIRECTIONS FOR EXECUTION OFWORKS

4.5.1 Setting Out

The Contractor shall be responsible for the true and proper setting out of works. If at any time during the progress of the work any error shall appear in any part of the work, the Contractor shall rectify the errors. The checking of any setting out by the Employer/ Architect shall not in any way relieve the contractor of his responsibility for the correctness thereof.

4.5.2 Engagement of labor

The Contractor shall employ labor in sufficient numbers to maintain the required rate of progress and Quality of work. No child labor will be employed by the Contractor.

The contractor shall comply with all the provisions of Minimum wages Acts, Industrial Disputes Acts, ESI Acts.

The Contractor shall indemnify the Employer against any payment to be made under And for observance of the Regulations aforesaid without prejudice to his right to claim Indemnity from his sub- contractors.

The contractor shall provide at his own cost for the protection of the works and for the Safety of those employed on works or the Public.



4.5.3 Water and Power Requirements

All arrangements for water and Power required shall be made by the Contractor at his own costs and nothing extra on this account shall be paid to him. Similarly filtered water required for drinking purposes for the laborers shall also be arranged by the Contractor at his own cost.

The contractor shall make necessary arrangements for procuring petrol/ diesel for machinery or for Power generation to ensure uniform progress of work in the event of Power failure.

No extension of time of completion of the contract shall be allowed on account of Power failure.

4.5.4 Disruption of Progress

The Contractor shall give written notice to the Architect whenever progress of work likely to be delayed. The notice shall include details of the drawings or order required and of why and when it is required and of any delay likely to be suffered if it is late.

If for any reason, within reasonable time, the Architect is unable to give directions, and the work suffers, then the Architect shall take such delay into account in determining any extension of time to which the Contractor is entitled.

4.5.5 Rectification of Defects

If it appears to the Architect that any work has been executed with imperfect workmanship or inferior material, then the Contractor shall rectify/ reconstruct the part so specified.

4.5.6 Samples

Samples of all materials to be used in works, shall be submitted for approval to the Architects, within four days of commencement of Contract.

The costs for preparing samples will be borne by the contractor.

4.5.7 Inspection Of Works

All works in execution stage or executed shall be open to inspection and supervision of the Architect/ his representatives. During the Visit of the Architect, the Contractor or his representative should be available on site.

4.5.8 Preparation of Program Schedule

The contractor, in consultation with the Architect shall prepare a program schedule of the various activities, before commencing of the works.



4.5.9 Extension of Time for Completion

If the contractor shall desire an extension of the time for completion of the work, on his having been unavoidably hindered in its execution or on any other ground, he shall apply in writing to the Architect within 3 days of occurrence of such hindrance and the extension he so desires.

The Architect, in consultation with the Employer shall, if, in his opinion will authorize such extension of time as may be proper.

4.5.10 Liquidated Damages For Delay

The time and Date stipulated in the contract for the completion of the work shall be deemed to be the essence of the contract. If the contractor fails to carry out the works within the stipulated time or the extended time if given, then he shall pay to UTTAR PRADESH GRAMIN BANK a sum of Rs 5,000/- per week as Liquidated damages, for the period the works remain unfinished. The total amount of such a penalty shall not exceed 7.5% of the total Contract Price.

4.5.11 Defects Liability Period

The Contractor shall be responsible to make good and remedy at his own expense within such period as may be stipulated by the Employer any defects which may develop or may be noticed before the end of 12 months from the Certified Completion date and intimation of which has been send to the contractor within 7 days of the expiry of the said period.

If the Contractor, while rectifying the above defects, damages any other area of the site, will make good the related defects also at his own expense. In case he does not do so then the same would be got done by the Employer and expenses would be deducted from the amount due to the contractor.

4.6 MEASUREMENTS AND PAYMENTS

4.6.1 Final Bill

Final bill supported with consolidated measurements of the full work executed shall be submitted by the contractor, the same will be verified by the Architect within Three weeks of Completion of Works.

After Verification, the Architect will give seven day notice to the Contractor to Countersign the bill as a token of acceptance or intimate in writing his intention to dispute. If the Contractor fails to take appropriate action within the prescribed period as above, then the bill finalized by the Architect shall be final and binding on the Contractor.

Income tax deductions will be made as per the prevailing rates from the contractor's on account bills.

4.6.2 Claim for Interest

No Claim for interest will be entertained by **the Employer, with respect to any money balances as lying with the Employer.**



4.6.3 Rates For Extra, Additional, Altered or Substituted works.

The rates for additional, altered or substituted work shall be worked out in accordance with the following provisions, in their respective order.

i) If rates for similar works are directly available in the Contract for the work, the contractor is bound to carry out at the same rates as available in the contract.

ii) If rates are not directly available in the contract, then they will be derived from the rates for a similar class of works as are specified in the contract.

iii) If the rates cannot be determined, then the Contractor shall submit a detailed cost analysis as per market rates for same. The Architect will settle such claims.

4.7 GUARANTEES

4.7.1 Quality Of Work

The Contractor shall guarantee that the materials and workmanship are the best of their respective kinds for the service intended and that all items of work will be free from all inherent defects in workmanship and materials. He shall also guarantee that the works will not fail in any respect due to quality of materials, workmanship and method of construction.

The Specifications assume a proper degree of Skill on the part of the Contractor and Workmen Employed. The Contractor shall consult the Architect, whenever in his judgment variation in the methods of Construction or in the quality of material would be beneficial or necessary to fulfill the guarantee called for. Such variations may be made by the Contractor, only when authorized by the Architect.

4.7.2 Cost of Execution of work or repair, etc.

All works of repair shall be carried out by the contractor at his own expense if the necessity thereof shall in the opinion of the Architect be due to the use of materials or workmanship not in accordance with the contract or on account of neglect or failure on the part of the contractor to comply with any obligation expressed or implied on the contractor's part under the contract.

4.7.3 Remedy on Contractor's failure to carry out the works required.

If the contractor shall fail to do any such work as the aforesaid required by the Architect. The Employer shall be entitled to carry out such works at the contractor's own cost and recover the same from any money that may become due to the contractor.

4.7.4 Contract Valid during Guarantee Period

This contract shall remain valid and in force until the expiry of Guarantee Period.



4.8 RESCINDING/ TERMINATE CONTRACT

4.8.1 In any case under any clause of this contract, the contractor has rendered himself liable to pay compensation amounting to whole of his retention deposit in hands of Employer, the Architect in consultation with the Employer, on his behalf shall have power to adopt any of the following courses-

- a) To rescind the contract (of which rescission notice in writing to the contractor shall be conclusive evidence)
- b) To employ a contractor paid by the Employer and to supply materials to carry out the work or any part of the work, debiting the contractor with the cost of the labor and the price of the materials.
- c) To measure up the work of the contractor and to take such part of the work of the contractor as shall be unexecuted out of his hands and to give it to another contractor to complete. In this case any expense which may incur in excess of the sum which would have been paid to the original contractor, if the whole work had been executed by him, shall be borne and paid by the original contractor and may be deducted from any money due to him by the Employer.

In the event of any of the above courses being adopted by the Architect, the Contractor will have no claim to compensation to any loss sustained by him.

4.8.2 Termination Of the Contract

If at any time after the commencement of the work the Employer for any reason whatsoever not require the whole or part thereof as specified in the tender to be carried out, Architect shall give notice in writing of the fact to the Contractor who shall have no claim to any payment or compensation whatsoever on account of any profit or advantage which would have derived from the execution of the work.

4.8.3 Jurisdiction

The contract and its operation shall be governed by the laws of India, for the time being in force. The contract shall deemed to have been entered into at BALLIA.

4.8.4 Bye Laws and Local Authorities

The contractor shall conform to the provisions of any Govt. Acts and regulations of Local Authorities. Contractor would pay all charges and fees for towards Stacking, etc. The Contractor shall keep the Employer indemnified against all penalties and liabilities incurred in connection with the said contract.

The contract will be governed by the Indian Contract Act, Indian Sales Act and all other relevant laws.



4.8.5 Arbitration

All disputes related to the said contract shall be referred to the arbitration of the person appointed by the Employer. All rules will be subject to Arbitration Act 1940, or any statutory modification or re-enactment thereof.

It is a term of the contract that if the Contractor does not make any demand for arbitration in writing within 30 days of receiving the intimation from the Employer that bill has been certified for Payment, the claim of the contractor will be deemed to have been waived absolutely barred and the Employer shall be discharged and released of all liabilities under the contract.



उत्तर प्रदेश ग्रामीण बैंक
UTTAR PRADESH GRAMIN BANK

(सरकार के स्वामित्वाधीन अनुसूचित बैंक)
(Scheduled Bank Owned by Government)

SECTION –VI

SPECIAL CONDITIONS OF CONTRACT



SECTION VI

6.1 Insurance for Works

The contractor before commencing on execution, without limiting his obligation shall insure the works against all acts of God, at his own costs and keep them insured till the completion of the project, in the joint names of the Employer and the contractor, for the full amount of the Contract.

The Contractor shall deposit the policy and receipt for the premiums with the Employer within 7 days from the date of signing of the contract. In case the Contractor fails to do so, then the Employer can make the required Policy and deduct the amount from the Contractors amount due.

6.2 Insurance in respect to damage to persons and property

The contractor shall be responsible for all injury to persons, animals or things and for all structural and decorative damage to property which may arise from the operation or neglect of himself or any other person employed by him.

The clause shall be held to include any damage to buildings whether immediately adjacent or otherwise. The Contractor shall indemnify the Employer and hold him harmless in respect of all and any expenses arising from any such injury or damage to persons or property.

The Contractor shall reinstate all damages of every sort mentioned, due to his contract work to the property of third parties.

The Employer shall be at liberty and is empowered to deduct the amount of any damage or compensation levied on him due to the negligence of the Contractor.

Such insurance will not limit or bar the liability and obligation of the contractor to deliver the works to the Employer complete in all respects as per the contract. In case of loss or damage, the money payable under any insurance shall be received and retained by the Employer until the works are finally complete and such money shall then be credited to the Contractor in final settlement of accounts.

Date :- 06-10-2025

**SCHEDULE OF QUANTITY TENDER FOR FURNISHING WORK OF UTTAR PRADESH
GRAMIN BANK -BAHUARA BRANCH DIST- & R.O. BALLIA-1**

S.NO.	ITEM OF WORK	QTY	UNIT	RATE (Rs.)	AMOUNT (Rs.)
1	Bank Low ht. Counter 2'-6'' Wide Made out of 19mm thick Board with drawer unit and Front side 12mm thick Etching Glass supported with teak Wood Or Aluminium member with 1.0mm thick Laminate on the top & drawer unit shall be Provided on one side while with space for CPU By its side. Pull out tray on slide shall be Provided on each counter for keeping keyboard. All the exposed edges shall have 6 mm th. TW Lapping duly polished. Inside surface shall be Enamel painted two coats over primer coats. It Shall be locks & handles etc. Provision for wire Management shall be made. Complete work as Per branch Manager/Architect Satisfaction.	9.0	Rft.		
2	P/F of Bank Cash Counter in partition two level Cash counter 5'-0'' long (with 3'-10'' and 2'-6'' Height) counter for customer to be 1'-6'' wide And counter to be 3'-0'' wide with drawer unit Made out of 19mm thick board with 1.0mm thick Laminate on top and front and other internal Surface to be painted/Polished complete as per Item no. 1	5	Rft.		
3	P/F of Cash cabin partition front-over the counter Supported on 2''x1-1/2'' sal- wood frame work Cover with 8.0 mm thk. Etching glass supported of 1''x1/2'' beading with book window in size 5''x6'' Center of the counter with 2''x2'' spacing aluminium Grill will be fixed in front of Partition side partition supported 2''x1-1/2'' sal Wood well seasoned structure with a cost of anti Termite treatment up to 3'-0'' height framing of Inside area with 2''x1-1/2'' sal wood section 2'-0''c/c horizontal and vertical with both side 6mm thick ply & 1.0mm thick laminates both side. The upper portion up to 4'-0'' height shall be of 2-1/2''x2''x2-1/2'' Aluminum grill will be fixed Complete with all accessories and labour.	95.0	Sft.		

4	P/F of B.M Cabin Low Ht. (4'-6'' High) Partly glazed Laminated portion in Advance Manager Cabin The under framing shall be of 2''x2'' aluminium section for under framing at A max. Distance of 2' in each direction. 6mm th. Waterproof ply shall be fixed on two side and 1mm the laminated shall be pasted over it with B Chemical adhesive. Provision shall be made for Passage of electric / data cable and switch board. T.W molding melamine polished shall be fixed Wherever necessary. Bottom 4'' width shall Have skirting upper 1'-6'' height shall have 5mm thk. Plane glass.(All paneling & Partition work framing by aluminium section as per specify)	148.0	Sft.		
5	P/F of Low Ht. (4'-6'' High) Laminated portion For UPS Space The under framing shall be of 2''x2''sal wood (Anti termite Treatment) for Under framing at a max. distance of 2' in each Direction . 6mm th. Waterproof ply shall be Fixed on two side and 1 mm the laminated shall Be pasted over it with chemical adhesive.	16	Sft.		
6	P/F Low ht. partition Wicket gate &Other Side Partition all Specification as item No. 5.	16	Sft.		
7	Providing and fixing in position double leaf Powder coated Aluminium Entrance Door Made of 14 guage thick sheet. All member Shall be of 4''x1-3/4'' section and bottom Rail shall be of 5''x1-3/4'' section with 6mm Thick clear sheet glass including 4'' dia 2.0 Nos handles 10'' long 2.0 Nos, Tower bolts, Floor spring 2.0 Nos lock etc. complete.	98.0	Sft.		
8	P/F Godrej Night latch.	2.0	Nos.		
9	P/F f Godrej mortic lock	2.0	Nos.		
10	P/F of Door closer I.S.I mark	1	No.		
11	Providing and fixing Writing desk in Position box type Wooden writing in public Space of approximate size 4'-0'' x 2'-0'' Made out of 19mm thick good approved Quality ply with 6'' to 9'' wide pigeon hole Type compartments in the front façade boxing For keeping pay-in-ship, book literature etc. These writing table's must have laminates 1.0 mm thick on top writing desk and two side of the boxes. With beeding lipping, moulding and painting / polishing complete.	1	No.		
12	Suggestion Box	1	No.		
13	Check drop Box	1	No.		

14	Providing and fixing Aluminum grill in cash Cabin Grill size 2'-1/2"x2"x2'-1/2" will be Fixed complete with all accessories & labour.	40	Sft.		
15	Providing and fixing in position Notice boards Of approximate size 3'-0" x 2'-0" and 6" deep Made out of 19mm thick ply with fully glazed Shutter in front and soft board with felt cloth Lining at the back inclusive of good approved Quality lock to this shutter, hinges, fixtures, Handle etc. and front laminate/painted complete As directed by bank architect.	1	No.		
16	Providing and Fixing in position side units Made out of 19mm board with 1.0 mm Laminate with slidding hinged shutters (made out of 12mm thick ply with 1.0 mm Thick laminate on it) complete with handles Etc. Size 4'-0" x 1'-6" x 2'-6"	2	No.		
17	Providing and fixing Column paneling Paneling all specification as per item no. 4	218	Sft.		
18	Providing and fixing in position Branch Manager Table (Size 6'-0" x 3'-0") made Out of 19mm thick water proof board with 1.0 mm th. Laminated on all exposed surface (others external surface shall be painted with Two coats of enamel paint over one coat of Primer) It shall have one unit on one side while Provision to be made for pull out tray on slides. The table to be finished in TW/H.W Lipping & Godrej lock, handles footrest, latches all Complete.	1.0	No.		
19	Providing and Fixing in position Officer Table (Size 5'-0"x2'-6")made out of 19mm. Thk. Water proof board with 1.0 mm. th. Laminated on all exposed surface (others external Surface shall be painted with two coats of enamel Paint over one coat of primer) It shall have one Unit on one side while.	1.0	No.		
20	Providing & fixing Wooden Filling Cabinet 1'-6" deep to be fixed on the wall frame made out of 19mm thick commercial ply with siding hinge shutters made out of 12mm thick ply with 1.0mm laminate on the front & side other other inernal surface to be painted as complete with handle, lock, wall catches etc.	106.0	sft		

21	False Ceiling (Armstrong) Providing and fixing in position false ceiling in armstrong 600 x 600 x 15/16 mm dune supreme RH 99 prima tile with regular edge frame work as specified by armstrngcompany with suspenders making necessary frame work for A.C. Ducting for diffusers and light fitting.	0.0	sft		
22	False Ceiling (Gypsum) Providing & fixing with necessary scaffolding frame in 22 guage GI channel/angle, placed at appropriate grid, fixed to RCC slab, beam, wall etc. with fasteners/screws finished with 12.0mm Gypsum sheets joints covered with POP slurry/tape. Rates shall include painting (One Coat of putty, one coat of primer coat and tow coats of acrylic paints.) Rates shall include providing necessary cut-outs & additional support frames for electrical fixtures, A.C. grills, vertical drop up to 1'6" etc. item includes finishing with painting base work and finishing in plastic paint of white colour. (Note:- No extra payment shall be given for design. However, the visible area of the vertical side at the intersection of Gypsum & Armstrong False ceiling shall be paid.)	0.0	Sft.		
23	Wall Panneling All Sides With	0	Sft.		
24	Meter Box (3'-0"x4'-0") all specification as item No.5	12.0	Sft.		
				Total Furnishing Work Rs.	
Note :- All Glass Etching & Bank Logo all Suitable Place					
			Furnishing	Total Rs.(A) Rs.	
			Electrical	Total Rs.(B) Rs.	
	TOTAL (A+B)(Rs.)				
	GST 18%				
	SAY GRAND TOTAL				

**Detail Tender for Electrical Work LAN Cabling work of Bahuara
Branch-Uttar Pradesh Gramin Bank Ro-& Distt.- Ballia-1**

Sl.No.	Particulars	Qty.	Unit	Rate/Unit Rs. P.	Amount Rs. P.
1.	S/F of plug socket board consisting of 3 plug 5 Amp, three pin, three switch and one indicator with 1.5 sq mm separate circuit wiring for computer .	9	No		
2.	S/F of UPS earthing-S/burying of Dual pipe technology (Pipe in Pipe) earthingelectrode having GI 80mm O/D pipe with 25 micron coating, 3metres long. The space between two pipes to be filled with Highly conducive & Non corrosive chemical compound. The vacant space between pipe & hole shall also be filled with Compound all around. The job also includes S/F of GI strip clamp with two holes (with SS/GI bolts & nuts) on the electrode& taking two earthing leads of 4mm dia copper wire (Assumed length of 10m -beyond 10m to be paid extra)upto Main panel complete in all respects with guaranteed E/N voltage of less than 2 volts and resistance less tahn 1ohms. The 4mm dia Cu. earth wire shall be terminated on a separate 6way earthlink. The connections for Panel earthing& earth bus in the panle should be taken from this earthlink	2	No		
3	S/W 10 Amp, Plug point with 2.5 sq mm copper wire in counter with continuous earthing wire complete in all respect with modular switches /socket.	6	No		
4	S/F of LED Batten 20 watt light Fitting with 1.5 sq mm wiring complete in all respect including modular switches	17	No		
5	S/F of 20 Amp plug point with 2.5 sq mm wiring including modular switches /socket with continuous circuit wiring.	6	No		

6	Providing & Fixing of wall mounted fans (400dia) complete with 1.5 Sq mm wiring and modular switches. The work to include making hole in wall	7	No		
7	Supplying and Fixing of cabin fans (400Dia) in cash cabin/ in 1.5 sq mm wiring and modular switches.	1	No		
8	Supplying and Fixing of circuit wiring for computer in 2.5 sq mm copper wire.	7	No		

Sl.No.	Items of Work	Qty.	Unit	Rate/Unit Rs. P.	Amount Rs. P.
10	Supplying and Fixing of exhaust fan in toilet/hall 15 1inch dia 1.5 sq mm wiring and modular switches.	2	No		
11	S/F of ceiling fan (1200 dia) with hooks in rooms with adding rod of suitable length wherever necessary including 1.5 sq mm wiring and modular switches and regulator	3	No		
12	S & F of 12 way SPN DB double door with 10No SP MCB and 1 no DPMCB 40 AMP for computer	2	No		
13	Sub main wiring of UPS input and UPS output power supply with 2 no 6 sq mm No. 4 sq mm copper flexible wire in PVC conduit pipe. (payment as/actual length on site)	21	Mtr		

Sl.No.	Items of Work	Qty.	Unit	Rate/Unit Rs. P.	Amount Rs. P.
14	Supply and fixing on board 3 no KIT KAT cut out 200 amp with neutral link on board	1	Job		
15	S/F 63 Amp Changeover	1	No		
16	S/F 63 Amp Main Switch	1	No		
	LAN Cabling				
17	Supplying and drawing CAT 6 PVC insulated and Sheathed LAN cable through PVC conduit including testing, commissioning etc.as required.	121	Mtr		
18	Supply and fixing of RJ modem Jack for computer including making connection, soldering etc	8	No		
19	Supply and Fixing of Patch Card with CAT 6 Jack	8	No		
20	AC POINT Point Wiring with 2 No. 4.0 Sq.mm and 1 No. 2.5 Sq.mm Multistrand Copper Wire & 20/25 Amp. Metal clad plug & Socket DB complete in all respect as required by the Bank (for 1.0 & 2.0 Tr AC)	5	Nos.		
				Total Rs.	

GRAND TOTAL Rs. -----

(Rs. ----- Lacs ----- Thousand ----- Hundred ----- Only.)

Total Work Furnishing Rs.----- +Total Work Electrical Rs. ----- =Rs.

**----- Says Combined Total Work Furnishing &Electrical Rs. ----- (----- Lacs
----- Thousand Only**

PROJECT - SPECIFICATION FOR FURNITURE WORKS.		
BANK- UTTAR PRADESH GRAMIN BANK		
*ALL WORKS TO BE DONE AS PER TENDER CONDITIONS.		
A	FURNITURE ITEMS	
1	LAMINATES (IS-2046) / VENEER	GREEN LAM / CENTURY / ARCHID / FORMICA / SUNMICA
2	COMMERCIAL PLY (IS-303) / WATERPROOF PLY (IS-710) / BLOCK BOARD (IS-1659) / FLUSH DOOR (IS- 2202)	ARCHID/ CENTURY / GREEN /SAMRAT
3	ADHESIVES	FEVICOL / VAMICOAL
4	LOCKS	GODREJ
	MULTIPURPOSE GROUP LOCK	E-MPL1-22 / E-MPL1C-22 (EBCO)
	NIGHT LATCH	8812 (GODREJ)
	CYLINDRICAL LOCK (SS MATT FINISH)	3792-WITH KEY AND 3786-KEYLESS (GODREJ) / C120SS (EUROPA)
	MORTISE DEAD LOCK (TWO WAY)	8815(GODREJ)
	MORTISE LOCK WITH DOOR HANDLE	MATIZ 8083(GODREJ)
5	DRAWER CHANNELS	GODREJ/ HATTICH/ OZONE
	TELESCOPIC CHANNELS (ZINK PLATED)	STDS35(I)35/ STDS25(I)35/ STDS50(I)35/ STDS60(I)35
	BOTTOM CHANNELS (POWDER COATED)	BMDS 35/ BMDS 37/ BMDS 55/ BMDS 60 (EBCO)
6	GENERAL HARDWARE	SS MATT FINISH
	DOOR STOPPER	I) BLACK/IVORY/BROWN/SILVER COLOR POWDER COATED DS1 (EBCO) II) SPRING TYPE BLACK/BROWN/IVORY COLOR POWDER COATED (ECGL'S STERLING)
	HINGES	I) 3"/4"/5"/6" 1.8MM TH. SS MATT FINISH (SUZU) II) 75X12X19 1.2 MM TH. SS MATT FINISH FOR STORAGE (SUZU) III) AUTO CLOSE HINGES – SLIP ON HINGE- EURO / CLICK ON HINGE-I (EBCO) FOR STORAGE
	HANDLES 'D' OR 'C' TYPE	1) 3"/4"/6"10MM DIA SS 202 MATT FINISH (ANJALI)
	TOWER BOLT	3"/4"/6"/8" BRASS EXTRUDED SS MATT FINISH (OSWAL)
	SLIDING CHANNEL	EBCO MAKE APPROVED BY ARCHITEC/BANK.
7	FLOOR SPRING	RITZ,HYPER,EVERITE (ISI Mark)
8	DOOR CLOSURE	RITZ,HYPER,EVERITE (ISI mark)

9	PATCH FITTINGS FOR DOOR AND FIXED GLASS PARTITION (TOP/BOTTOM PATCH, PIVOT, PATCH LOCK, L ARM, L CONNECT, CONNECTOR, FLOOR SPRING, HANDLE, PLASTIC PROFILE)	GODREJ / XL C SERIES(DORMA) / OPF SERIES (OZONE)
10	GLASS / MIRRORS	SAINT GOBAIN / MODI
11	ALUMINUM SECTION	JINDAL / HINDALCO
12	WINDOW BLINDS	VISTA / AEROLUX/HUNTER DUGLUS / MAC
13	POLISH / PAINT	ASIAN PAINTS / BERGER / NEROLAC
14	PARTICLE BOARDS	NOVAPAN / KITLAM/DECO BOARD
15	COMPUTER ACCESSORIES	
	CPU HANGER/ SHELF	SIDE MOUNTED IS CPU HL SM (INNOFITT) /CPUSM(EBCO) ,
	CABLE MANAGER (60MM)	I) METAL - CO60ZN1(EBCO) II) PVC - CO 60 (EBCO) BLACK/IVORY/GREY COLOR
16	ACP PANEL	TIMEX / ALU DECOR / EURO
19	WHITE FILM FOR GLASS	CRYSTAL / SONA MAKE VINYL FROSTED FILM
B	PAINTS	ICI, ASIAN,DULUX, BERGER, NEROLAC, JOHNSON & NICOLSAN
1	ANTI CORROSIVE PAINT	TIKITAR, FINCOAT
2	RED OXIDE	ASIAN, DULUX,NEROLAC
3	POLISH	ASIAN MELAMINE
4	EXTERIOR PAINTS	DULUX WEATHERSHIELD OR APP. EQUIVALENT
5	ENAMEL PAINT	ICI, DULUX, ASIAN, NEROLAC
C	FALSE CEILING	
1	GYPSUM BOARD	GYPROC (SAINT GOBAIN)
2	FRAMING WITH COMPLETE SYSTEM	GYP STEEL ULTRA (SAINT GOBAIN), RAMCO FUJI
3	HILUX BOARDS	RAMCO OR APPROVED EQUIVALENT
4	MINERAL FIBRE TILES CEILING WITH COMPLETE SYSTEM	ARMSTRONG/SAINT GOBAIN/USG

PROJECT - SPECIFICATION FOR ELECTRICAL WORKS.

BANK- UTTAR PRADESH GRAMIN BANK

***ALL WORKS TO BE DONE AS PER TENDER CONDITIONS.**

D	APPROVE MAKE LIST FOR ELECTRICAL	
1	PVC rigid conduits & Accessories:	1.5 mm thick (MMS) ISI and FIA approved - Precision / Vraj / Nihir / BLP / PFI / Anchor / Polycab make. (Only white coloured pipes FRLS type to be used.).
2	L.T. Cables:	Havells / KEI / Polycab / Finolex.
3	Wires (FRLS):	Havells / KEI / Polycab / Finolex.
4	Main Distribution Boards:	MDS Legrand (Lexic) / Hager / Crabtree XPOA / Schneider (Eazy 9) / L & T EXORA / C & S Wintrip / Siemens Bitaguard.

5	ELCB / RCCB / Miniature Circuit Breaker:	MDS Legrand (Lexic) / Hager / Crabtree XPOA / Schneider (Eazy 9) / L & T EXORA / C & S Wintrip / Siemens Bitaguard.
6	Switch gears:	MDS Legrand (Lexic) / Hager / Crabtree XPOA / Schneider (Eazy 9) / L & T EXORA / C & S Wintrip / Siemens Bitaguard.
7	Change Over Switch:	HPL Socomac/ Havells / L & T / Hager.
8	Domestic fittings:	
	a) All Switching Modular Accessories.	MK Wrapped Wround Plus / Schneider Livia / L & T entis / Crabtree Verona / Salzer Elite / Legrand Myris / C & S Divino / SSK Ace.
	b) Holders / ceiling roses	Anchor
	c) Adhesive Tape	Bhor (Steel Grip) .
9	10 - 30 A Polycarbonate Socket & Top:	MDS Legrand (Lexic) / Hager / Crabtree XPOA / Schneider (Eazy 9) / L & T EXORA / C & S Wintrip / Siemens Bitaguard.
10	Telephone Wires / Cable:	Finolex / Havells / L & T / Polycab.
11	Telephone tag block:	Krone make.
12	Cable Lugs:	Dowell / Lotus / Jainson / 3 D.
13	Cable gland Single / Double Compression:	HMI / Comet / 3D.
14	Ammeter / Voltmeter:	AE / HPL /MECO/ Enercon make.
15	Selector switches:	L & T salzer / Kaycee make.
16	Indicator lamps:	LED type Teknic / Precifine/ Binay.
17	Connector strips:	Wago / Elmex make.
18	Lighting Fixtures :	Wipro / Philips / GE / Crompton. only
19	Exhaust fan (Light duty):	Khaitan / Crompton / Havells.
20	Ceiling Fan (5 star rated):	Crompton (High Breeze Plus) / Havells.
21	Wall mounted Fan (5 star rated):	Crompton (High Flow Wave) / Havells.
22	Data Cable - I / O Unit:	D - Link / Digi Link.

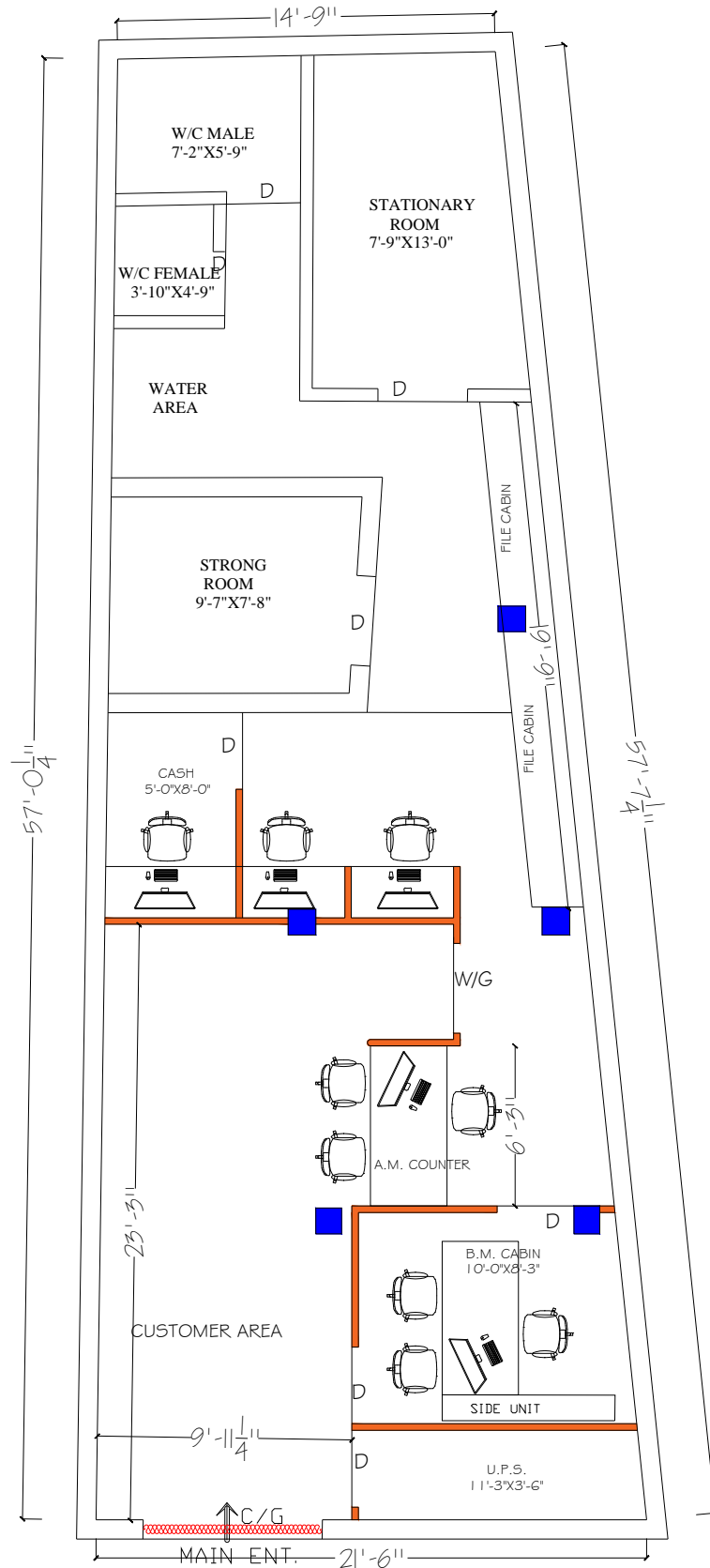

PROPOSED PLAN FOR:- PLAN -2
BARODA U.P. BANK, BRANCH-
BAHUARA

DRW. TITLE :- GROUND FLOOR
INTERIOR PLAN



Ar. RAJESH KUMAR SINGH (B.Arch)

VISION ARCH

Plot no. 166, V.D.A. Colony, Badalapur
(Chandmari) Varanasi M.No.9450165944
E.MAIL:- VARCH0036@GMAIL.COM